

[1] Example glazing unit: Toughened double glazed unit  
 - 6mm HST toughened outer pane  
 - 16mm argon-filled cavity, black warm edge spacer  
 - 8mm HST toughened soft coat low-E inner pane

[2] Example of roofing:  
 - Plain tiles at 120mm gauge with double overlap  
 - 50 x 30mm battens  
 - 4 x 2in rafters and trimmers

[3] Flashing kit:  
 - If specified, then supplied by GV  
 - Otherwise supplied by others  
 - All lead to be code 4 (apx. 1.8mm)  
 - All aprons to be of underlay at least 1m wide  
 - Consider clipping down flashings and soakers in severe exposures

[4] Mortar beds are NOT suitable for use with this product  
 - In case of damage to the glass, the entire unit is expected to be replaced

[5] Example of internal finish:  
 - Plasterboard spaced away from the rafters/structural trimmers using 2in timber  
 - Space between plasterboard and aluminium frame of Pitchridge insulated

[6] Fixings:  
 - Woodscrews and a selection of plastic packers supplied by GV

Please Note  
 These products can be very heavy. GV strongly recommend that a structural engineer is consulted when designing the structure(s) that will support the Pitchridge and the surrounding roof. The roofing materials & construction shown in these details are presented as an example only. This drawing does not constitute a structural proposal.

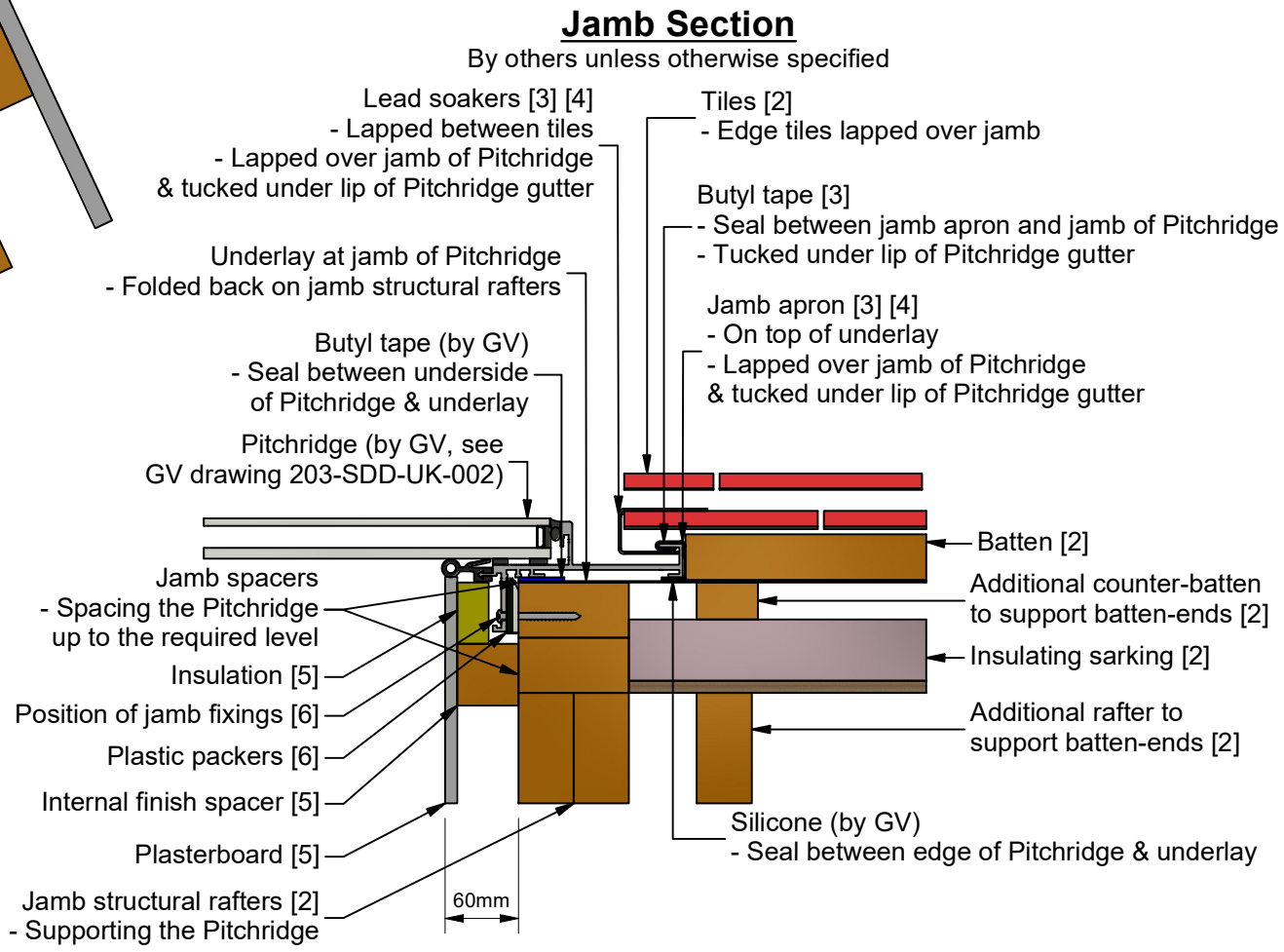

ESTIMATED WEIGHT	N/A	SCALE	N/A
------------------	-----	-------	-----

REVISION	DESCRIPTION	NAME/DATE
-	Initial Release	JME 11/Jul/2022

PROJECT	Pitchridge
TITLE / DESCRIPTION	General Arrangement Drawing General Arrangement for Pitchridge
CHECKED 1	

DRAWING NO.	203-SDD-UK-001	SHEET	1 OF 1
-------------	----------------	-------	--------