

GV STANDARD SLIDING OVER FIXED
ELECTRONICALLY OPERATED SLIDING ROOFLIGHT

Closed position

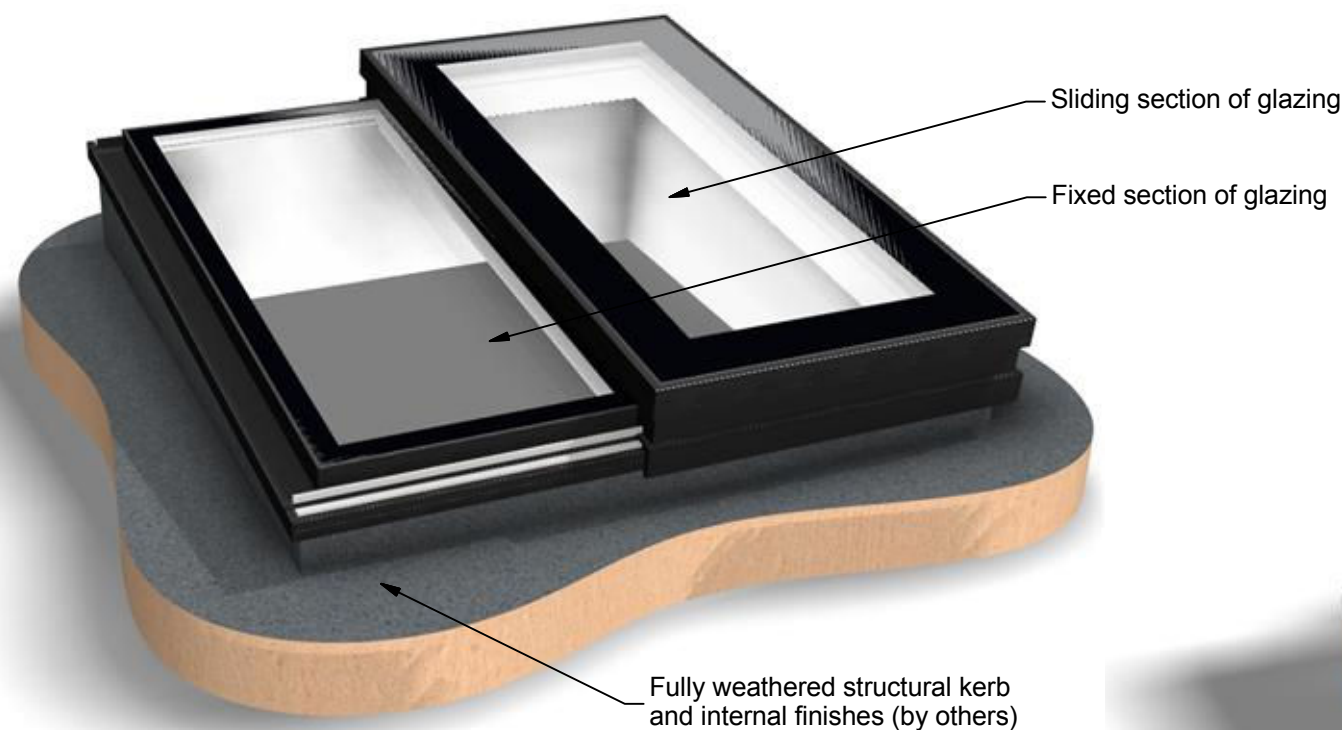

Open position

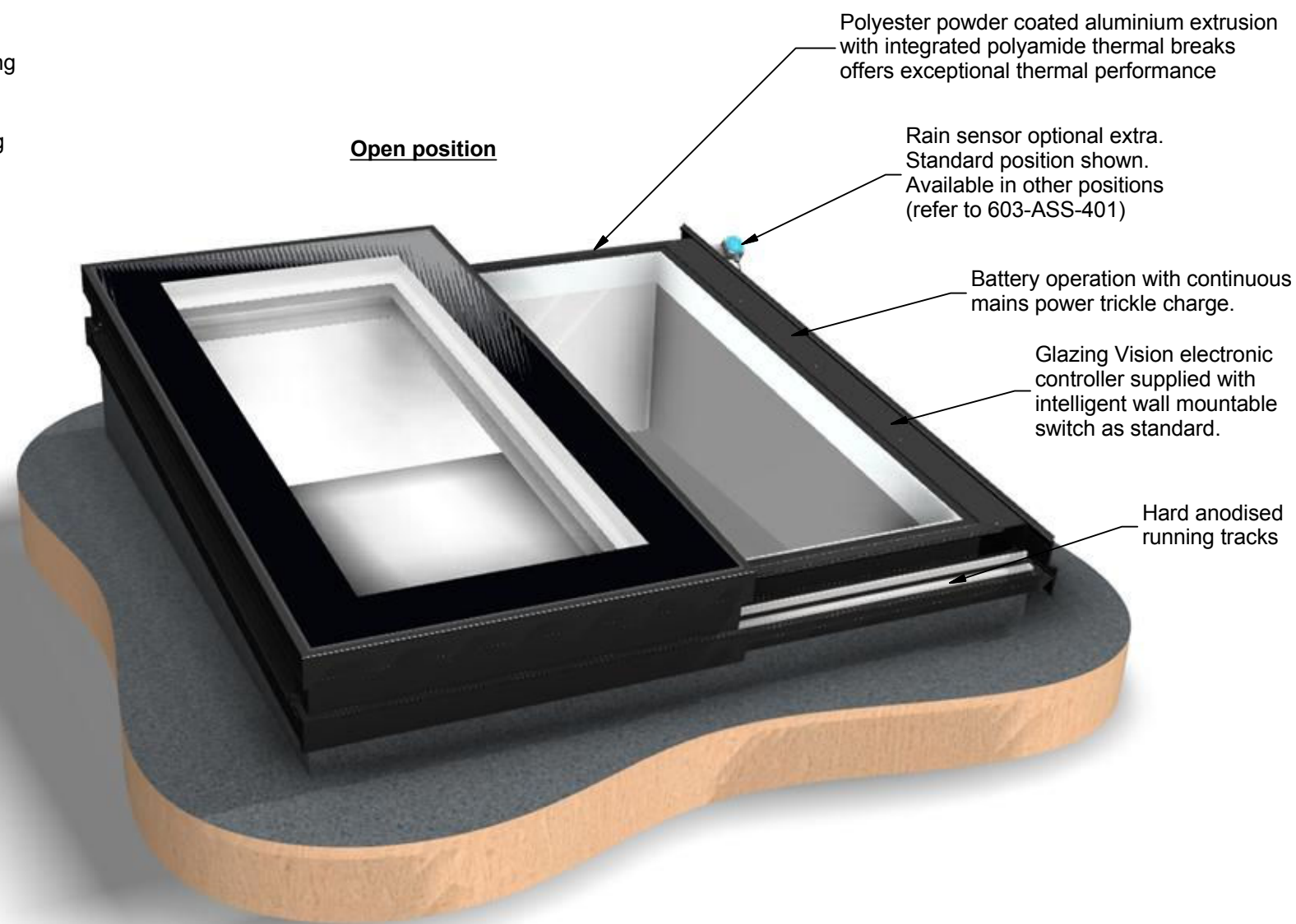

Internal drive detail

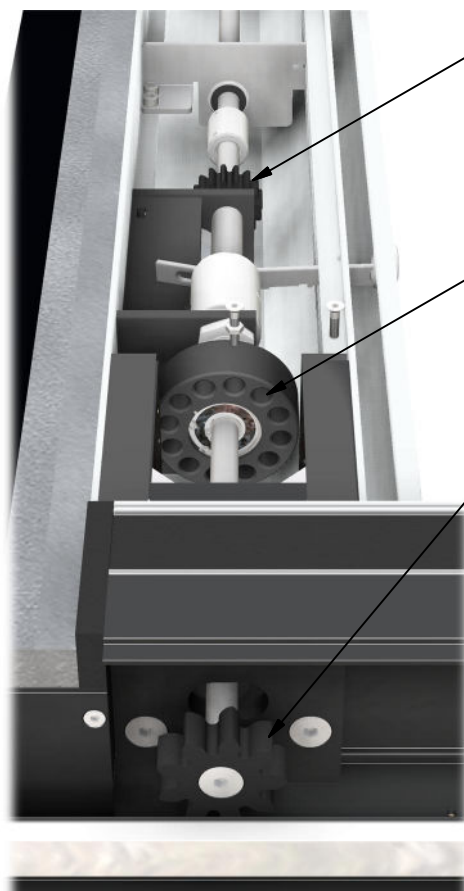

Twin drive motor mechanism comprising planetary motor concealed within centre framework ensures optimum performance.

One way clutch and solenoid security feature (patent applied for) as standard, allows unit to be closed without power. Hidden internal override allows unit to be opened without power.

Rack and pinion drive

FEA MODELLED FOR STRUCTURAL INTEGRITY

THERMALLY MODELLED FOR INDUSTRY LEADING EFFICIENCY

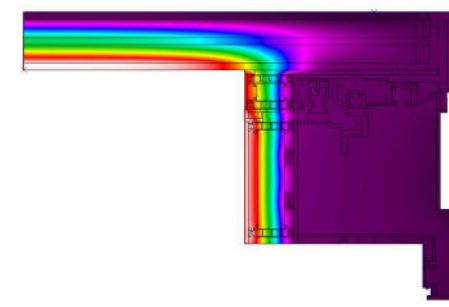

REQUIRES WEATHERED KERB (NOT SUPPLIED)
REFER TO DRAWINGS:
603-ASS-402
603-ASS-403
603-ASS-404
603-ASS-405
603-ASS-406
FOR DETAILS



Saw Mills Road
Diss
Norfolk
IP22 4RG
Tel: +44 (0)333 8000 881
Fax: +44 (0)333 8000 882
Email: sales@glazingvision.co.uk
Website: www.glazingvision.co.uk

IT IS GLAZING VISION'S POLICY TO CONTINUOUSLY DEVELOP AND IMPROVE OUR PRODUCTS. WE THEREFORE RESERVE THE RIGHT TO MODIFY OR CHANGE THE DETAIL DESIGN AT OUR DISCRETION AND WITHOUT PRIOR NOTICE. THIS DRAWING IS COPYRIGHT AND THE SOLE PROPERTY OF GLAZING VISION LTD. THE DESIGNS/INFORMATION IT CONTAINS ARE PRIVATE AND CONFIDENTIAL. IT MUST NOT BE COPIED, EXHIBITED OR COMMUNICATED TO THIRD PARTIES FOR ANY PURPOSE OTHER THAN THAT FOR WHICH IT WAS ISSUED WITHOUT THE WRITTEN PERMISSION OF GLAZING VISION LTD.

Third angle projection unless otherwise noted.
Tolerances:
Whole numbers = ±1mm
One decimal place = ±0.5mm
Two decimal places = ±0.2mm
All angles 90±0.5 degrees unless specified
IF IN DOUBT - ASK! DO NOT SCALE
Supplier to deburr & remove sharp corners

Rev	Revision Description	Drawn/Date
-	Initial release	PGW 25.02.2014

Product: 603 - GV Standard Sliding Over Fixed		Checked By: JamesB
Description: Product overview		Check Date: 25.02.2014
Materials: N/A	Drawn By: PGW	Drawing No: 603-ASS-400
Finish: Standard = RAL7015/RAL9010	Drawn Date: 25.02.2014	
Weight:		
Quantity: N/A		
Scale: NTS		