

GV STANDARD SLIDING OVER ROOF
ELECTRONICALLY OPERATED SLIDING ROOFLIGHT

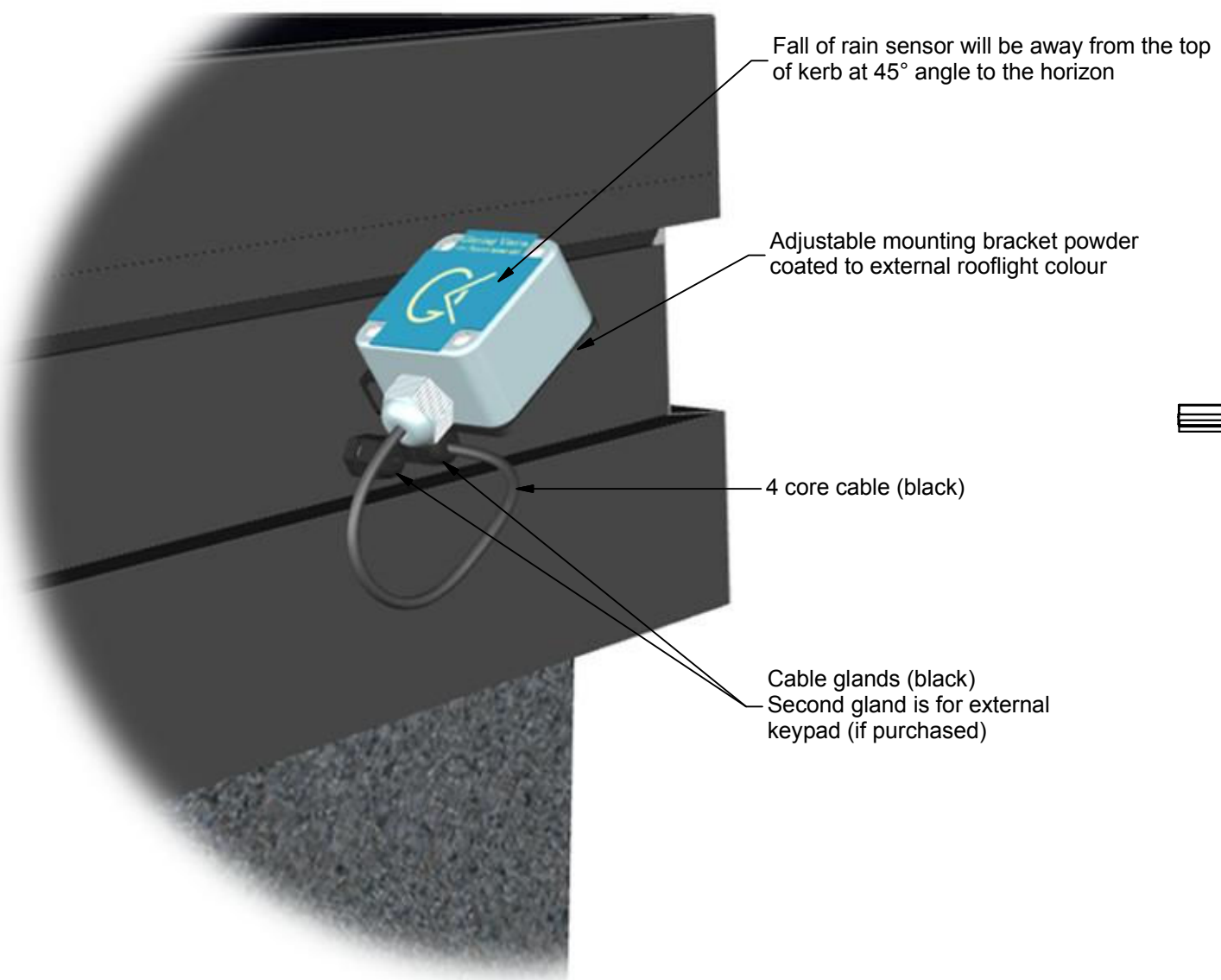

Fall of rain sensor will be away from the top of kerb at 45° angle to the horizon

Adjustable mounting bracket powder coated to external rooflight colour

4 core cable (black)

Cable glands (black)
Second gland is for external keypad (if purchased)

Plan view of Sliding Over Roof

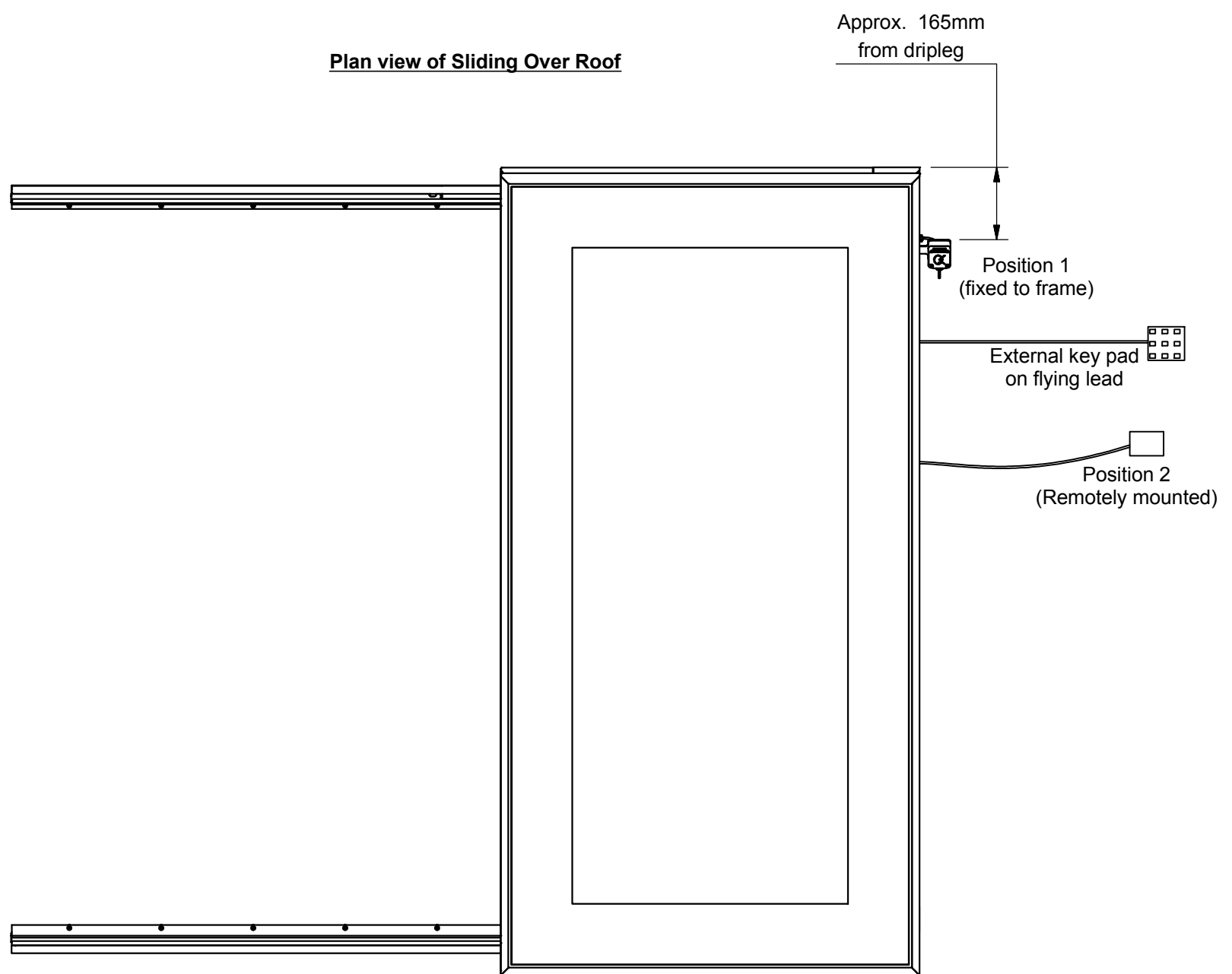

Approx. 165mm from dripleg

Position 1 (fixed to frame)

External keypad on flying lead

Position 2 (Remotely mounted)

When a rain sensor is required the customer is to specify a mounting position at the time of order to maximise exposure to the elements and avoid being in the rain shadow of the building.

There are 2 positions for the rain sensor. Either fixed to rooflight (position 1) or externally mounted with flying lead (position 2).

External keypads are always remotely mounted and supplied with flying leads.

NOTE: The rain sensor and keypad are optional extras.

GLAZING VISION
Saw Mills Road
Diss
Norfolk
IP22 4RG
Tel: +44 (0)333 8000 881
Fax: +44 (0)333 8000 882
Email: sales@glazing-vision.co.uk
Website: www.glazing-vision.co.uk

IT IS GLAZING VISION'S POLICY TO CONTINUOUSLY DEVELOP AND IMPROVE OUR PRODUCTS. WE THEREFORE RESERVE THE RIGHT TO MODIFY OR CHANGE THE DETAIL DESIGN AT OUR DISCRETION AND WITHOUT PRIOR NOTICE. THIS DRAWING IS COPYRIGHT AND THE SOLE PROPERTY OF GLAZING VISION LTD. THE DESIGNS/INFORMATION IT CONTAINS ARE PRIVATE AND CONFIDENTIAL. IT MUST NOT BE COPIED, EXHIBITED OR COMMUNICATED TO THIRD PARTIES FOR ANY PURPOSE OTHER THAN THAT FOR WHICH IT WAS ISSUED WITHOUT THE WRITTEN PERMISSION OF GLAZING VISION LTD.

Third angle projection unless otherwise noted.
Tolerances:
Whole numbers = ±1mm
One decimal place = ±0.5mm
Two decimal places = ±0.2mm
All angles 90±0.5 degrees unless specified
IF IN DOUBT - ASK! DO NOT SCALE
Supplier to deburr & remove sharp corners

| Rev | Revision Description | Drawn/Date | Product: 602 - GV Standard Sliding Over Roof | Checked By: |
|-----|-------------------------------|-----------------|---|-------------------------|
| - | Initial release | PGW 18.12.13 | Description: Rain sensor and external keypad positions | James L |
| A | Rain sensor positions revised | SW 29.11.17 | Materials: N/A Finish: N/A Weight: N/A Quantity: N/A Scale: NTS | Check Date: 29.11.17 |
| | | | Drawn By: PGW Drawn Date: 18.12.2013 | Drawing No: 602-ASS-401 |