

## Kerb mounting detail

PLEASE NOTE: All of the kerb structure to be constructed by the customer. Refer to S0009 for other wall configurations and kerb pitches. If any variables do not match this standard detail, contact Glazing Vision.

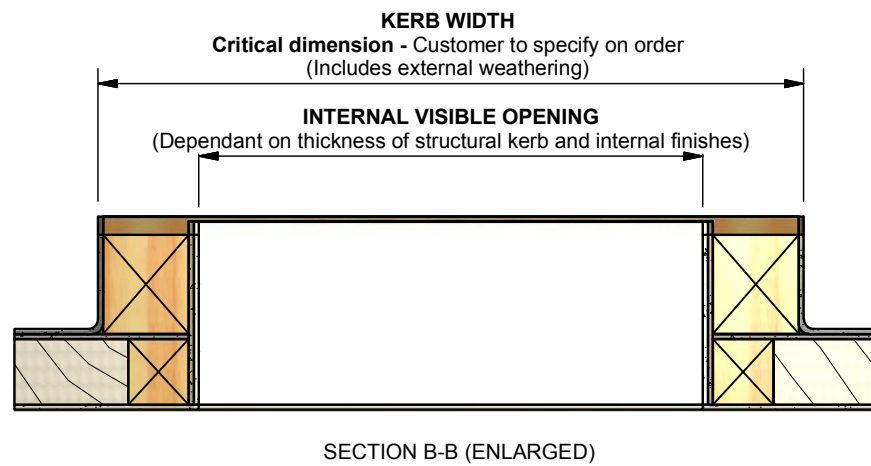
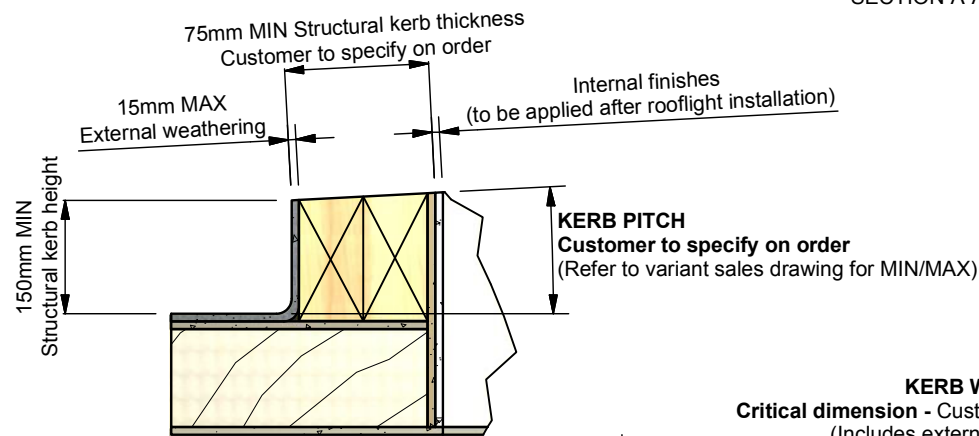
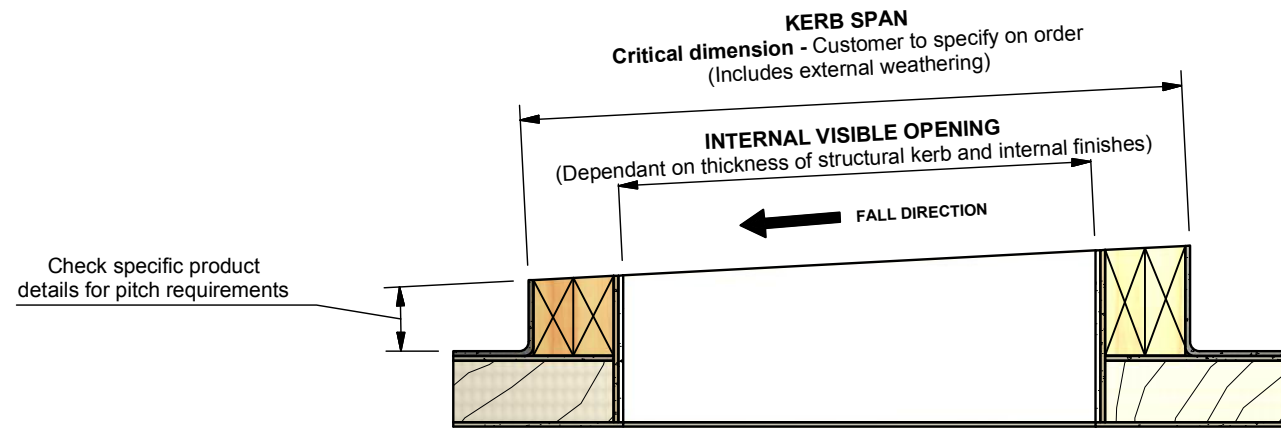
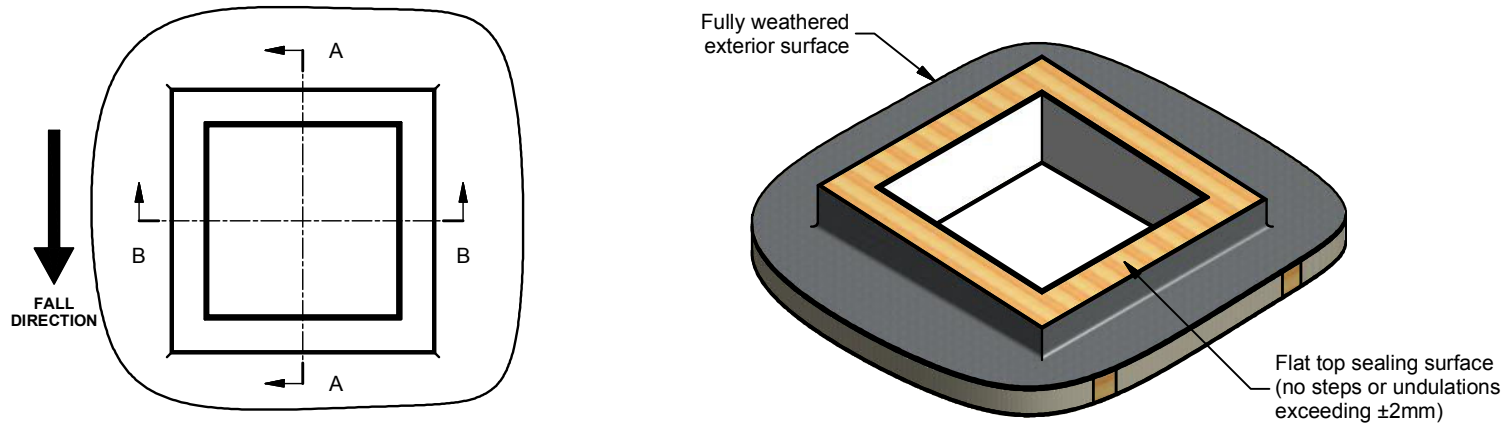

## Wall mounting detail

PLEASE NOTE: Configuration below is of a 1 wall abutted Flushglaze and is for illustrative purposes. Flushglaze units are available in various configurations. For further information, please seek assistance from our Sales team.

