

Third angle projection unless otherwise stated

THIS IS A STANDARD DRAWING. THE UNIT PURCHASED MAY VARY. THIS DRAWING DOES NOT INDICATE ACCURATE DIMENSIONS FOR ANY EXISTING STRUCTURAL COMPONENTS OR PRODUCTS.

DO NOT USE THIS DRAWING FOR ANY SITE LAYOUTS. ON-SITE PERSONNEL ARE RESPONSIBLE TO CONFIRM DRAWINGS VS SPECIFIC SITE CONDITIONS

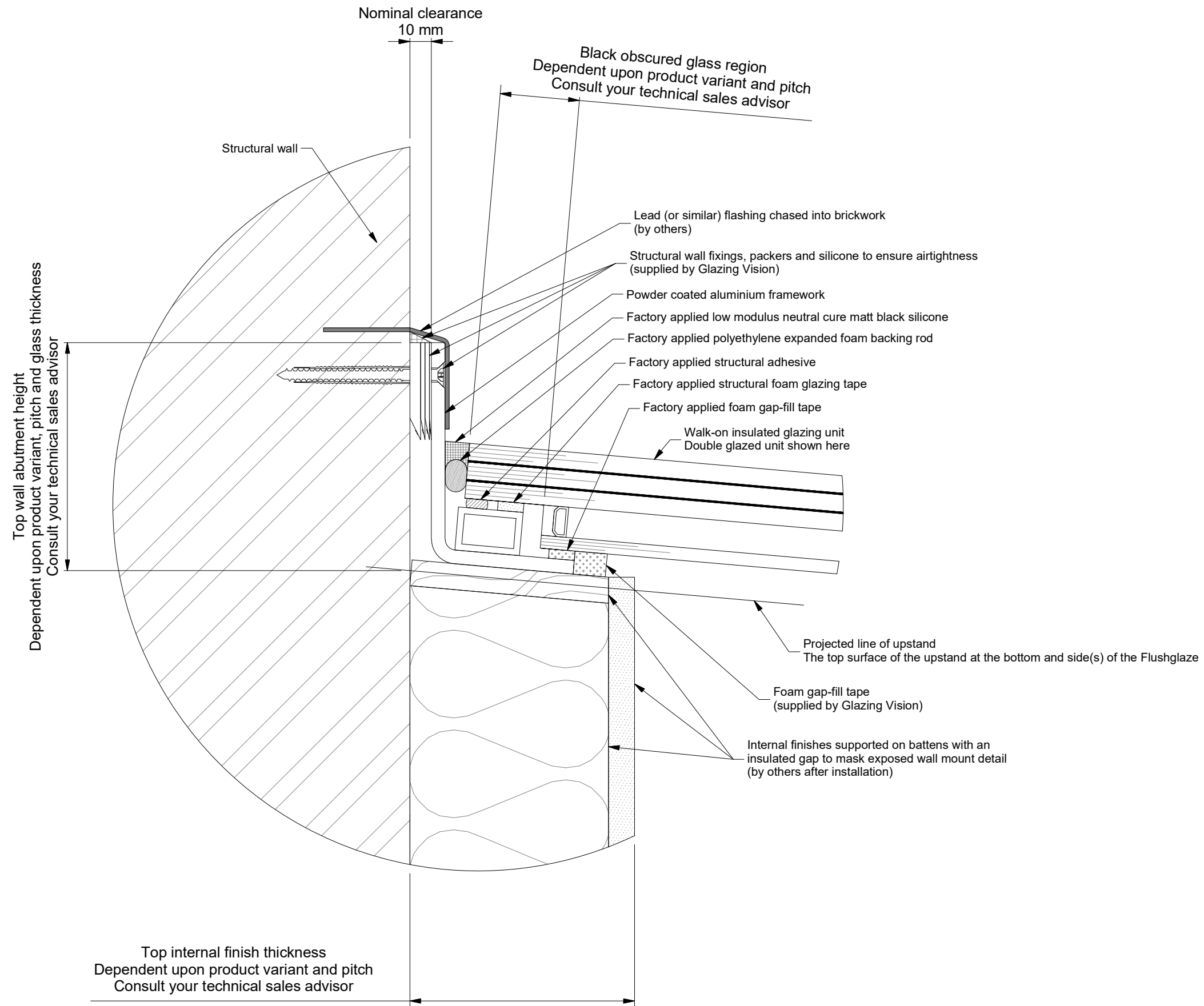

| | | | |
|------------------|-----|-------|--|
| ESTIMATED WEIGHT | N/A | SCALE | Not to scale <small>(UNLESS OTHERWISE STATED)</small> |
|------------------|-----|-------|--|

| REVISION | DESCRIPTION | NAME/DATE |
|----------|--|--------------------|
| - | Initial Release | JSL 16/Oct/2020 |
| A | Top internal finish thickness increased to conceal gap-fill tape | HL 21/Jan/2021 |
| | | |
| | | |

| | |
|------------------------------------|---------|
| PROJECT | |
| Walk-On Flushglaze Fixed Rooflight | |
| TITLE / DESCRIPTION | CHECKED |
| Top Wall Abutment Section Detail | HL |
| DRAWING NO. | SHEET |
| 402-ASS-068 | 1 OF 1 |