



## GV Standard Pitchglaze

201-ASS-100 v1.2 - Sales Drawing Pack

Including drawing numbers:

201-ASS-101 rev A  
201-ASS-102 rev A  
201-ASS-103 rev A  
201-ASS-104 rev A  
201-ASS-105

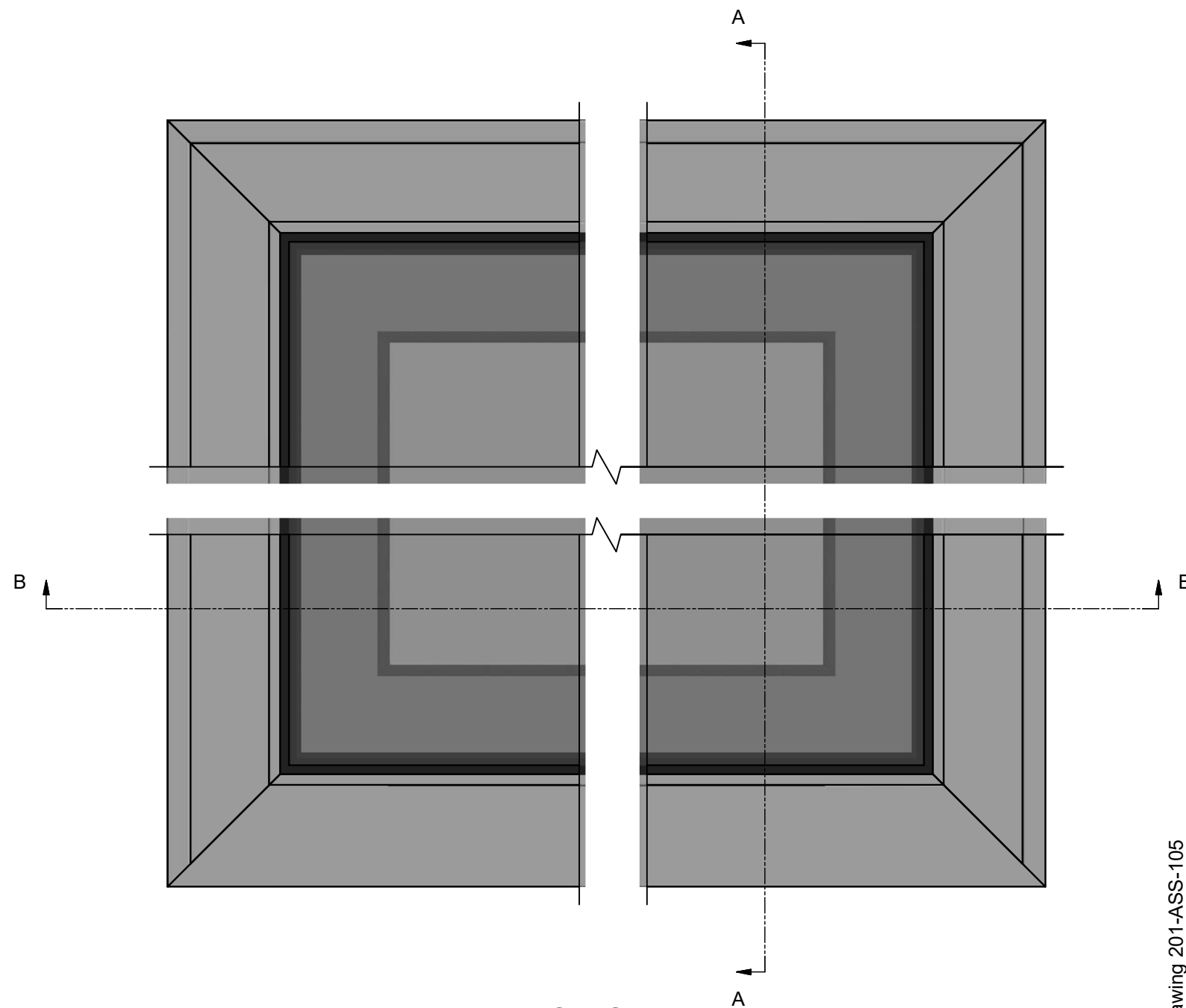

Section A-A

TOP  
(Head)

OUTSIDE

Internal Viewable Span  
This is the span used to specify the Pitchglaze

INSIDE

BOTTOM  
(Cill)

Supporting structure (e.g. trimmers)

Section B-B

OUTSIDE

Internal Viewable Width

This is the width used to specify the Pitchglaze

See GV drawing 201-ASS-105

Supporting structure (e.g. rafters)

For installation information,  
see GV drawings  
201-ASS-102  
201-ASS-103  
201-ASS-104

\* Value includes nominal 10mm tolerance

INSIDE

**GLAZING  
VISION**

Saw Mills Road  
Diss  
Norfolk  
IP22 4RG  
Tel: +44 (0)333 8000 881  
Fax: +44 (0)333 8000 882  
Email: sales@glazingvision.co.uk  
Website: www.glazingvision.co.uk

IT IS GLAZING VISION'S POLICY TO CONTINUOUSLY DEVELOP AND IMPROVE OUR PRODUCTS. WE THEREFORE RESERVE THE RIGHT TO MODIFY OR CHANGE THE DETAIL DESIGN AT OUR DISCRETION AND WITHOUT PRIOR NOTICE. THIS DRAWING IS COPYRIGHT AND THE SOLE PROPERTY OF GLAZING VISION LTD. THE DESIGNS/INFORMATION IT CONTAINS ARE PRIVATE AND CONFIDENTIAL. IT MUST NOT BE COPIED, EXHIBITED OR COMMUNICATED TO THIRD PARTIES FOR ANY PURPOSE OTHER THAN THAT FOR WHICH IT WAS ISSUED WITHOUT THE WRITTEN PERMISSION OF GLAZING VISION LTD.

Third angle projection unless otherwise noted.  
Tolerances:  
Whole numbers =  $\pm 1\text{mm}$   
One decimal place =  $\pm 0.5\text{mm}$   
Two decimal places =  $\pm 0.2\text{mm}$   
All angles  $90 \pm 0.5$  degrees unless specified  
**IF IN DOUBT - ASK! DO NOT SCALE**  
**Supplier to deburr & remove sharp corners**

Rev	Revision Description	Drawn/ Date	Product: 201 - GV Standard Pitchglaze MkII	Checked By:
-	INITIAL ISSUE	JSL 24/01/2018	Description: General dimensions	HL
A	TOLERANCES ADDED TO ASTERISKED (*) VALUES	JSL 24/06/2019	Materials: - Finish: - Weight: N/A Quantity: - Scale: NTS	Check Date: 24/06/2019
			Drawn By: JSL Drawn Date: 24/01/2018 Drawing No: 201-ASS-101	

## Head and Cill Section

By others unless otherwise specified

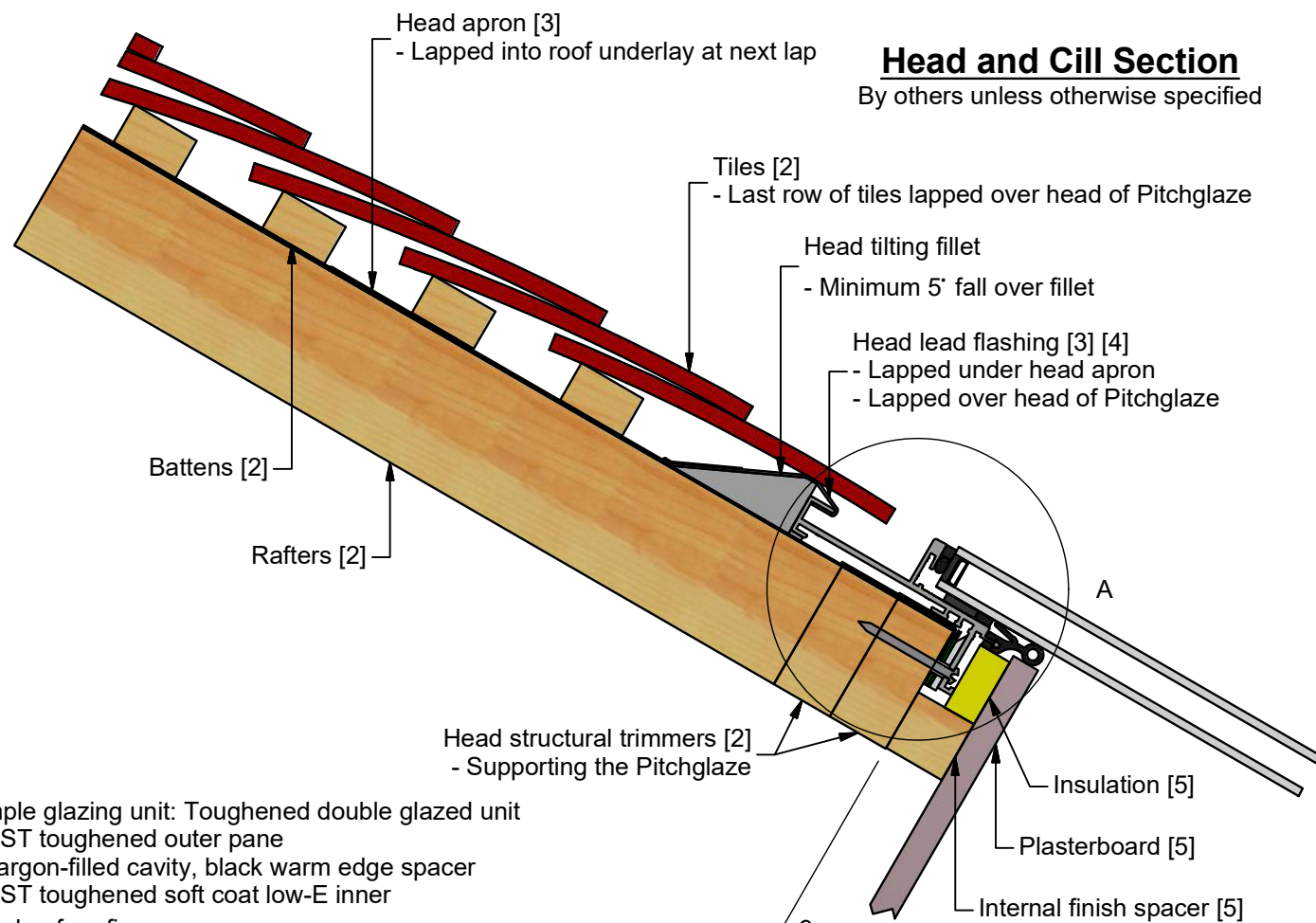

- [1] Example glazing unit: Toughened double glazed unit  
 - 6mm HST toughened outer pane  
 - 16mm argon-filled cavity, black warm edge spacer  
 - 6mm HST toughened soft coat low-E inner

[2] Example of roofing:

- Plain tiles at 120mm gauge with double overlap
- 50 x 30mm battens
- 4 x 2in rafters and trimmers

[3] Flashing kit:

- If specified then supplied by GV
- Otherwise supplied by others
- All lead to be code 4 (apx. 1.8mm)
- All aprons to be of underlay at least 1m wide
- Consider clipping flashings and soakers down in severe exposures

[4] Mortar beds are NOT suitable for use with this product

- In case of damage to the glass, the entire unit is expected to be replaced

[5] Example of internal finish:

- Plasterboard spaced away from the rafters/structural trimmers using 2in timber
- Space between plasterboard and aluminium frame of Pitchglaze insulated

[6] Fixings:

- Woodscrews and a selection of plastic packers supplied by GV

Please Note

These products can be very heavy. GV strongly recommend that a structural engineer is consulted when designing the structure(s) that will support the Pitchglaze and the surrounding roof. The roofing materials & construction shown in these details are presented as an example only. This drawing does not constitute a structural proposal.

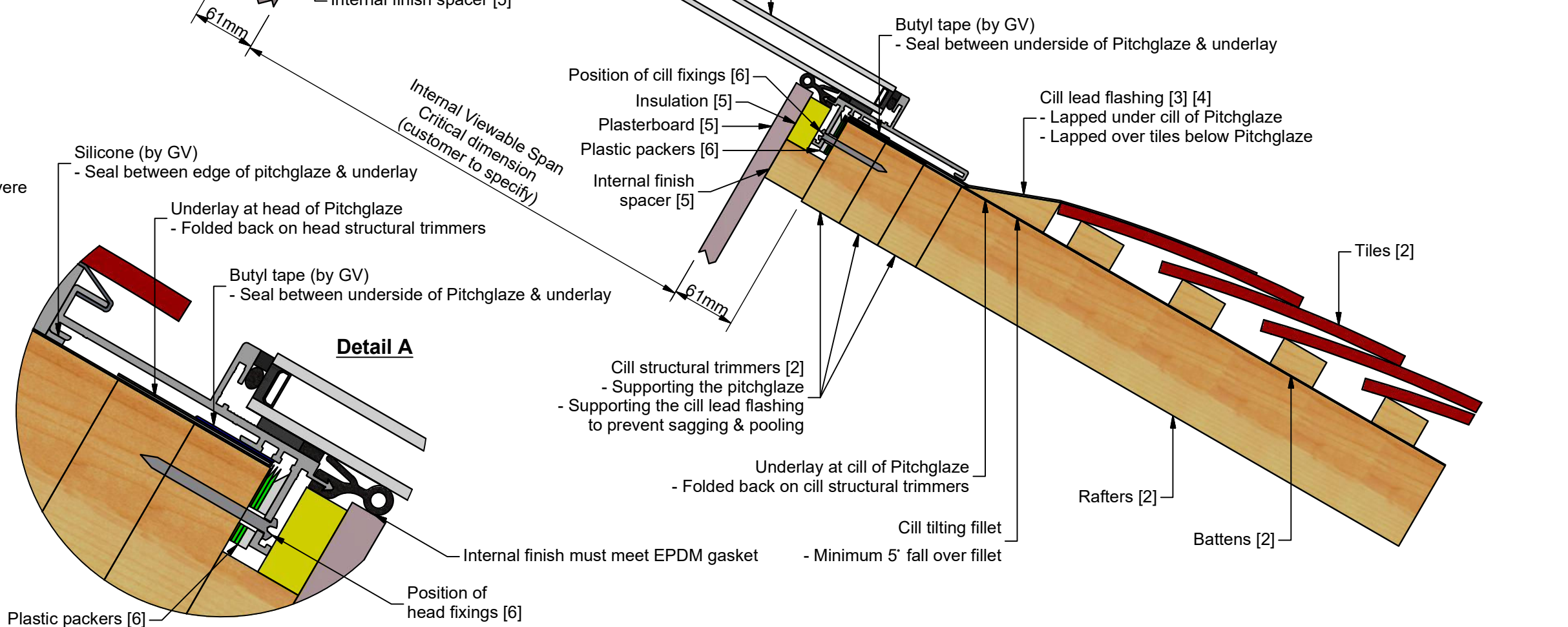

## Jamb Section

By others unless otherwise specified

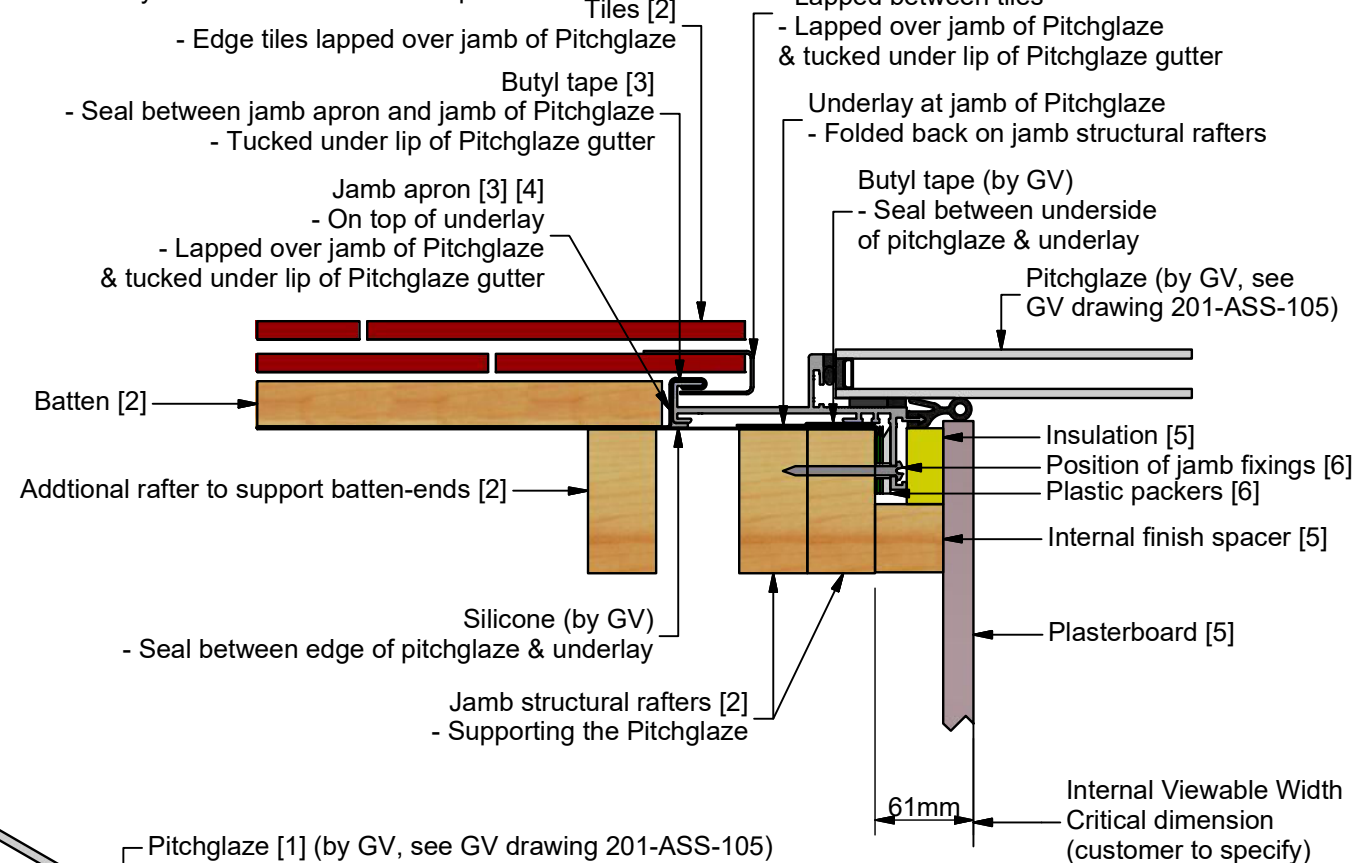

### Detail A

**GLAZING VISION**

Saw Mills Road  
Diss  
Norfolk  
IP22 4RG

Tel: +44 (0)333 8000 881  
Fax: +44 (0)333 8000 882  
Email: sales@glazingvision.co.uk  
Website: www.glazingvision.co.uk

IT IS GLAZING VISION'S POLICY TO CONTINUOUSLY DEVELOP AND IMPROVE OUR PRODUCTS. WE THEREFORE RESERVE THE RIGHT TO MODIFY OR CHANGE THE DETAIL DESIGN AT OUR DISCRETION AND WITHOUT PRIOR NOTICE. THIS DRAWING IS COPYRIGHT AND THE SOLE PROPERTY OF GLAZING VISION LTD. THE DESIGNS/INFORMATION IT CONTAINS ARE PRIVATE AND CONFIDENTIAL. IT MUST NOT BE COPIED, EXHIBITED OR COMMUNICATED TO THIRD PARTIES FOR ANY PURPOSE OTHER THAN THAT FOR WHICH IT WAS ISSUED WITHOUT THE WRITTEN PERMISSION OF GLAZING VISION LTD.

Third angle projection unless otherwise noted.  
Tolerances:  
Whole numbers =  $\pm 1\text{mm}$   
One decimal place =  $\pm 0.5\text{mm}$   
Two decimal places =  $\pm 0.2\text{mm}$   
All angles  $90 \pm 0.5$  degrees unless specified  
**IF IN DOUBT - ASK! DO NOT SCALE**  
Supplier to deburr & remove sharp corners

Rev	Revision Description	Drawn/Date	Product: 201 - GV Standard Pitchglaze MkII	Checked By:
-	INITIAL ISSUE	JSL 12/04/2018	Description: Standard Installation GA	HL
A	Difference between structural rafter/trimmer opening and internal viewable opening revised from 65mm	JSL 08/11/2018	Materials: AS SITE HARDWARE LIST Finish: - Weight: N/A Quantity: - Scale: NTS	Check Date: 08/11/2018
			Drawn By: JSL Drawn Date: 12/04/2018 Drawing No: 201-ASS-102	



## Head and Cill Section

By others unless otherwise specified

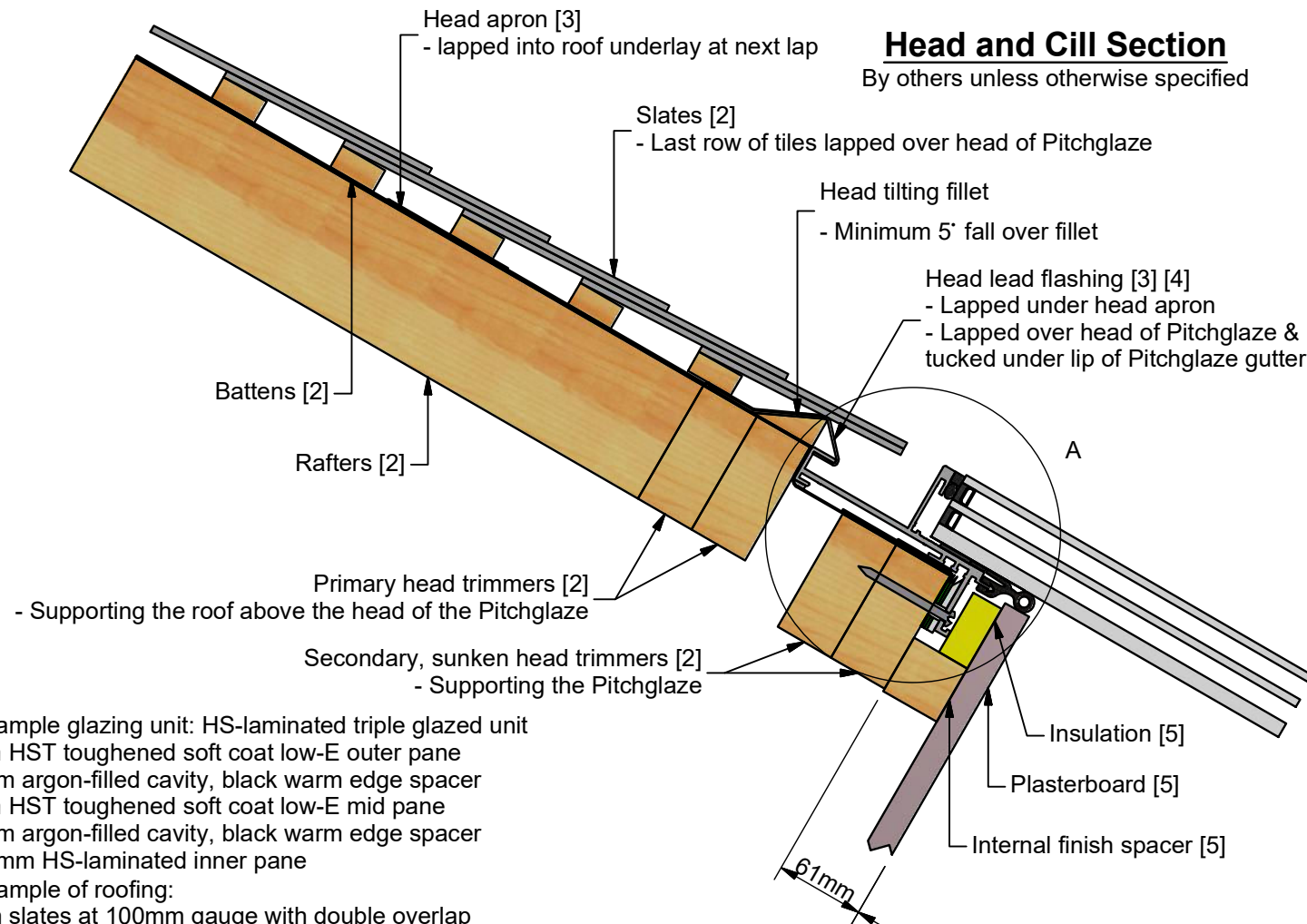

[1] Example glazing unit: HS-laminated triple glazed unit  
 - 6mm HST toughened soft coat low-E outer pane  
 - 14mm argon-filled cavity, black warm edge spacer  
 - 6mm HST toughened soft coat low-E mid pane  
 - 14mm argon-filled cavity, black warm edge spacer  
 - 11.5mm HS-laminated inner pane

[2] Example of roofing:  
 - Plain slates at 100mm gauge with double overlap  
 - 36 x 18mm battens  
 - 4 x 2in rafters and trimmers

[3] Flashing kit:  
 - If specified then supplied by GV  
 - Otherwise supplied by others  
 - All lead to be code 4 (apx. 1.8mm)  
 - All aprons to be of underlay at least 1m wide  
 - Consider clipping flashings and soakers down in severe exposures

[4] Mortar beds are NOT suitable for use with this product  
 - In case of damage to the glass, the entire unit is expected to be replaced

[5] Example of internal finish:  
 - Plasterboard spaced away from the rafters/structural trimmers using 2in timber  
 - Space between plasterboard and aluminium frame of Pitchglaze insulated

[6] Fixings:  
 - Woodscrews and a selection of plastic packers supplied by GV

Please Note  
 These products can be very heavy. GV strongly recommend that a structural engineer is consulted when designing the structure(s) that will support the Pitchglaze and the surrounding roof. The roofing materials & construction shown in these details are presented as an example only. This drawing does not constitute a structural proposal.

### Detail A

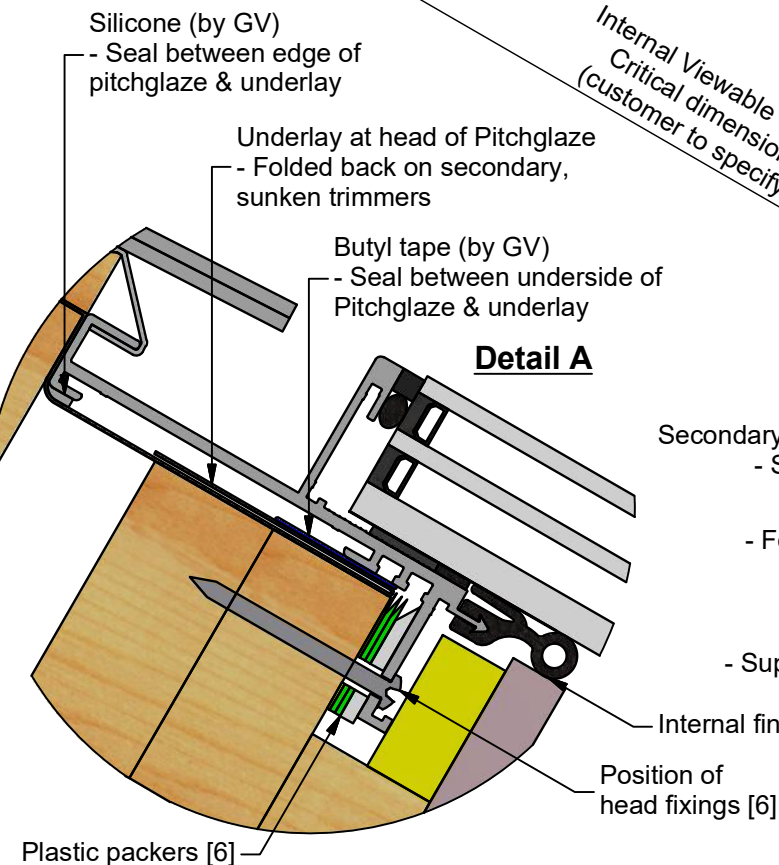

## Jamb Section

By others unless otherwise specified

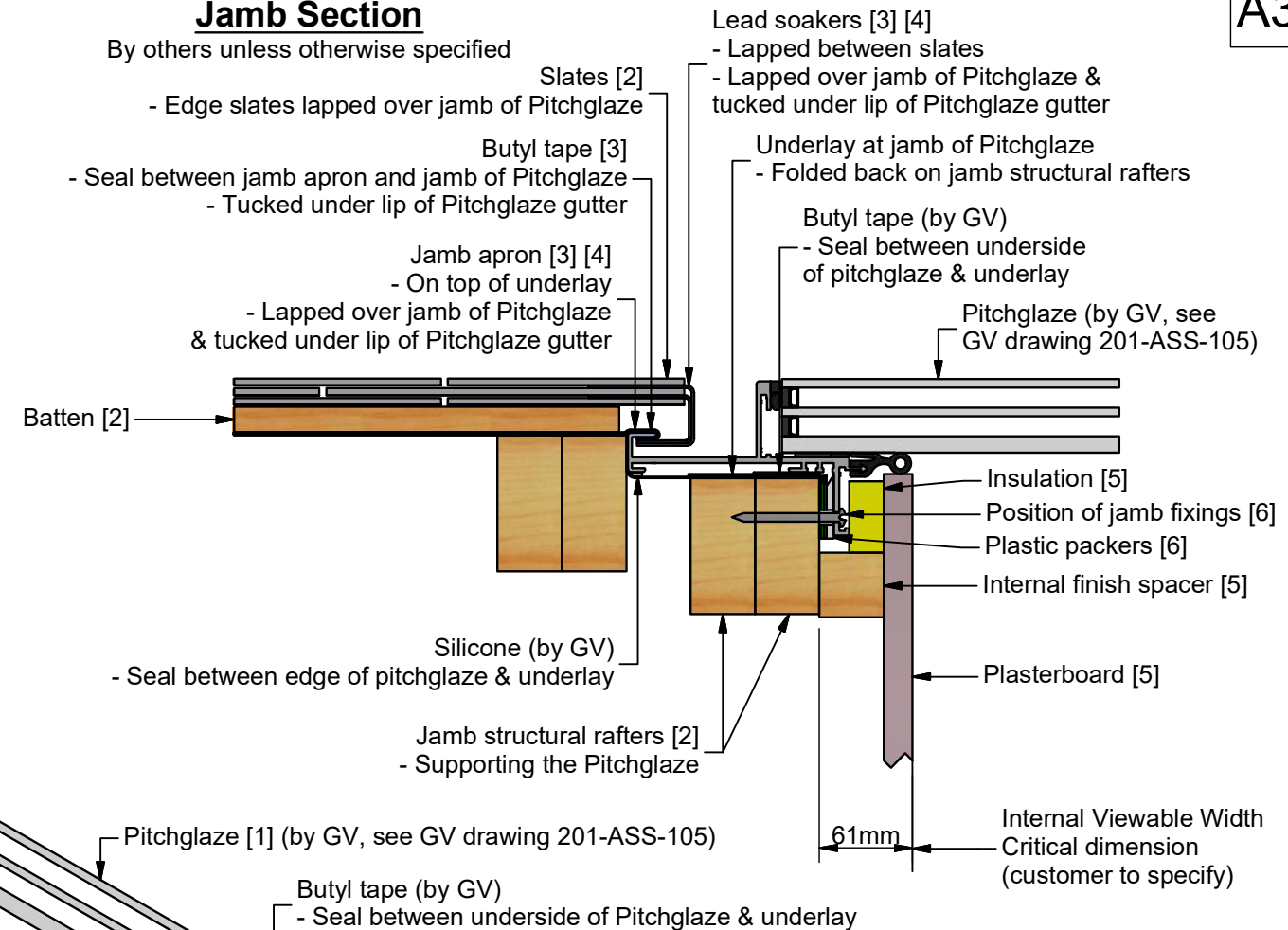

Position of cill fixings [6]  
 Insulation [5]  
 Plasterboard [5]  
 Plastic packers [6]  
 Internal finish spacer [5]  
 Secondary, sunken cill trimmers [2]  
 - Supporting the pitchglaze  
 Underlay at cill of Pitchglaze  
 - Folded back on cill structural trimmers  
 Cill flashing support  
 - Supporting the cill lead flashing to prevent sagging & pooling  
 - Supporting the secondary cill tilting fillet

Secondary cill tilting fillet  
 - Minimum 5° fall over fillet  
 - Underneath the underlay

Primary cill trimmers  
 - Supporting the roof below the cill of the Pitchglaze

**GLAZING VISION**

Saw Mills Road  
 Diss  
 Norfolk  
 IP22 4RG  
 Tel: +44 (0)333 8000 881  
 Fax: +44 (0)333 8000 882  
 Email: sales@glazingvision.co.uk  
 Website: www.glazingvision.co.uk

IT IS GLAZING VISION'S POLICY TO CONTINUOUSLY DEVELOP AND IMPROVE OUR PRODUCTS. WE THEREFORE RESERVE THE RIGHT TO MODIFY OR CHANGE THE DETAIL DESIGN AT OUR DISCRETION AND WITHOUT PRIOR NOTICE. THIS DRAWING IS COPYRIGHT AND THE SOLE PROPERTY OF GLAZING VISION LTD. THE DESIGNS/INFORMATION IT CONTAINS ARE PRIVATE AND CONFIDENTIAL. IT MUST NOT BE COPIED, EXHIBITED OR COMMUNICATED TO THIRD PARTIES FOR ANY PURPOSE OTHER THAN THAT FOR WHICH IT WAS ISSUED WITHOUT THE WRITTEN PERMISSION OF GLAZING VISION LTD.

Third angle projection unless otherwise noted.  
 Tolerances:  
 Whole numbers = ±1mm  
 One decimal place = ±0.5mm  
 Two decimal places = ±0.2mm  
 All angles 90±0.5 degrees unless specified  
**IF IN DOUBT - ASK! DO NOT SCALE**  
**Supplier to deburr & remove sharp corners**

Rev	Revision Description	Drawn/Date	Product: 201 - GV Standard Pitchglaze MkII	Checked By:
-	INITIAL ISSUE	JSL 12/04/2018	Description: Sunken Installation	HL
A	Difference between secondary, sunken rafter/trimmer opening and internal viewable opening revised from 65mm	JSL 08/11/2018	Materials: AS SITE HARDWARE LIST Finish: - Weight: N/A Quantity: - Scale: NTS	Check Date: 08/11/2018
			Drawn By: JSL Drawn Date: 12/04/2018 Drawing No: 201-ASS-103	



## Head and Cill Section

By others unless otherwise specified

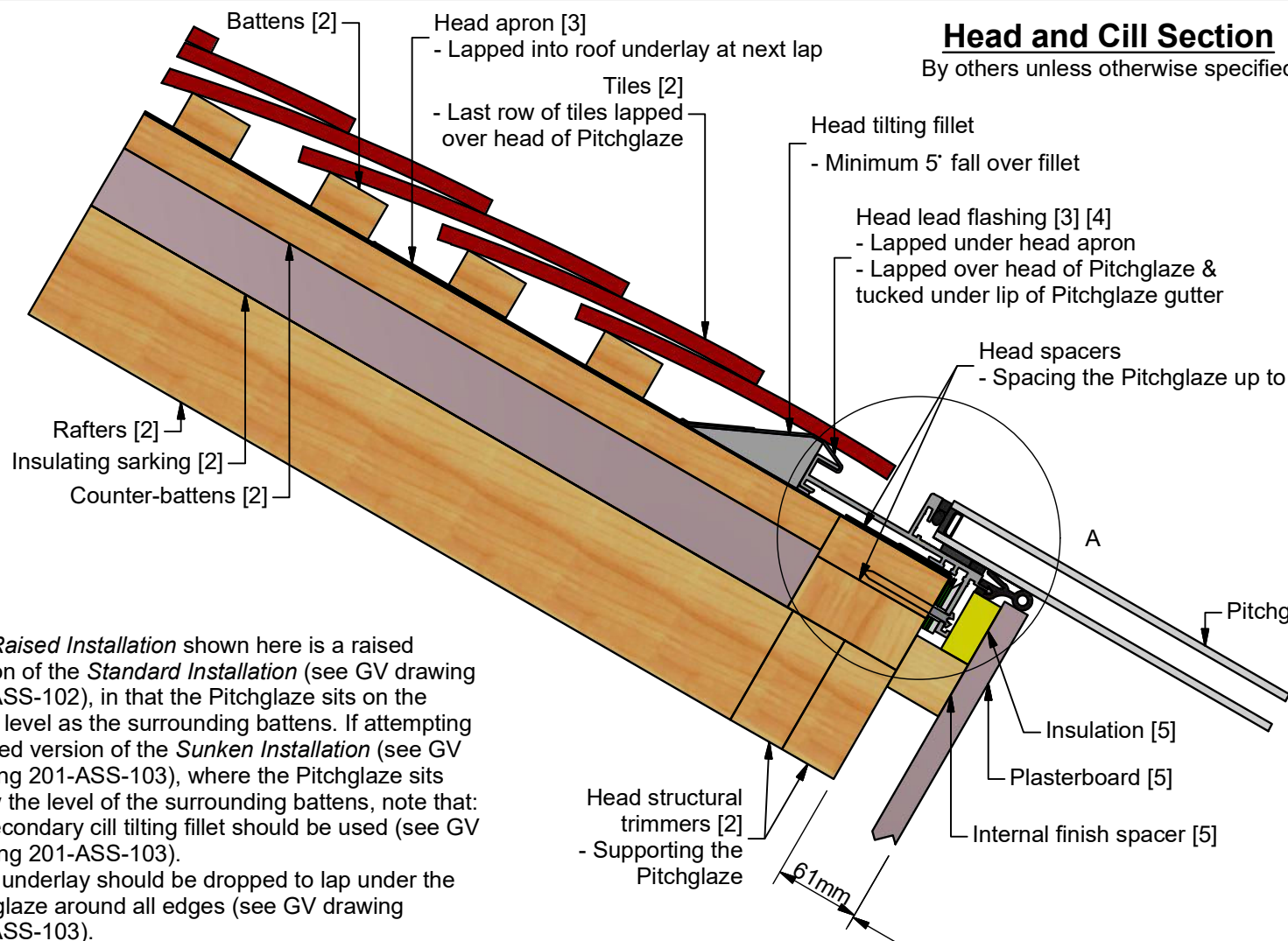

Note:

The *Raised Installation* shown here is a raised version of the *Standard Installation* (see GV drawing 201-ASS-102), in that the Pitchglaze sits on the same level as the surrounding battens. If attempting a raised version of the *Sunken Installation* (see GV drawing 201-ASS-103), where the Pitchglaze sits below the level of the surrounding battens, note that:

- A secondary cill tilting fillet should be used (see GV drawing 201-ASS-103).
- The underlay should be dropped to lap under the Pitchglaze around all edges (see GV drawing 201-ASS-103).

- [1] Example glazing unit: Toughened double glazed unit
- 6mm HST toughened outer pane
  - 16mm argon-filled cavity, black warm edge spacer
  - 6mm HST toughened soft coat low-E inner

- [2] Example of roofing:

- Plain tiles at 120mm gauge with double overlap
- 50 x 30mm battens & counter-battens
- 50mm insulating sarking
- 4 x 2in rafters and trimmers

- [3] Flashing kit:

- If specified then supplied by GV
- Otherwise supplied by others
- All lead to be code 4 (apx. 1.8mm)
- All aprons to be of underlay at least 1m wide
- Consider clipping flashings and soakers down in severe exposures

- [4] Mortar beds are NOT suitable for use with this product  
- In case of damage to the glass, the entire unit is expected to be replaced

- [5] Example of internal finish:

- Plasterboard spaced away from the rafters/structural trimmers using 2in timber
- Space between plasterboard and aluminium frame of Pitchglaze insulated

- [6] Fixings:

- Woodscrews and a selection of plastic packers supplied by GV

Please Note:

These products can be very heavy. GV strongly recommend that a structural engineer is consulted when designing the structure(s) that will support the Pitchglaze and the surrounding roof. The roofing materials & construction shown in these details are presented as an example only. This drawing does not constitute a structural proposal.

## Jamb Section

By others unless otherwise specified

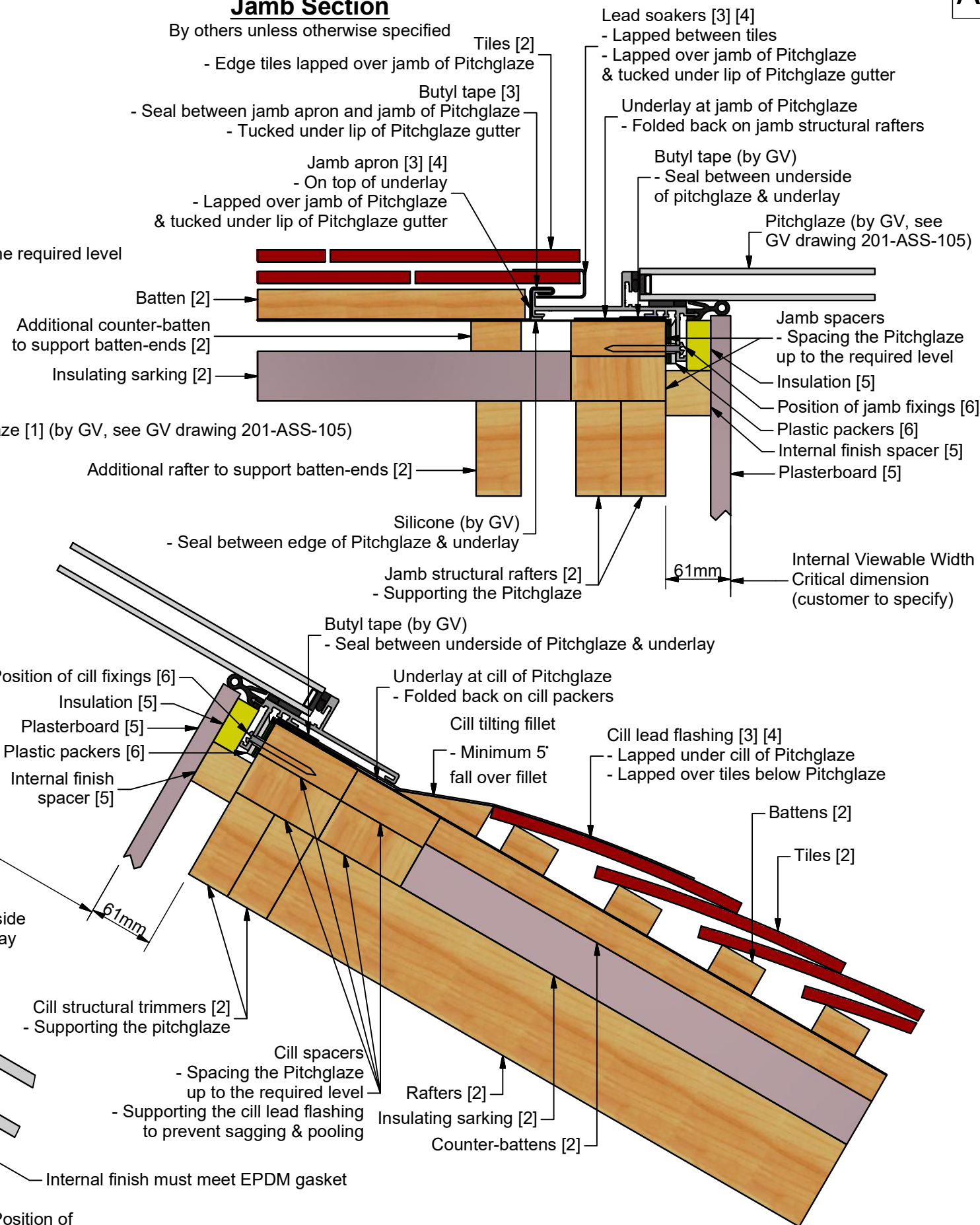

### Detail A

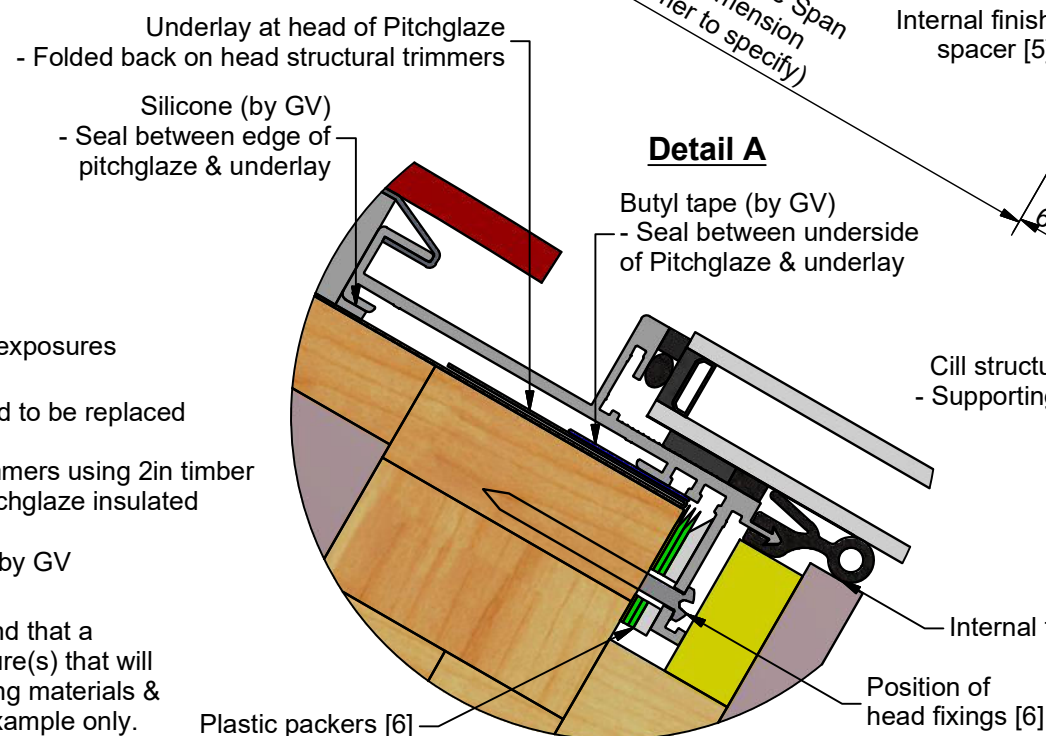

<div><div>GLAZING VISION</div><div>Saw Mills Road Diss Norfolk IP22 4RG</div><div>Tel: +44 (0)333 8000 881 Fax: +44 (0)333 8000 882 Email: sales@glazingvision.co.uk Website: www.glazingvision.co.uk</div></div>	IT IS GLAZING VISION'S POLICY TO CONTINUOUSLY DEVELOP AND IMPROVE OUR PRODUCTS. WE THEREFORE RESERVE THE RIGHT TO MODIFY OR CHANGE THE DETAIL DESIGN AT OUR DISCRETION AND WITHOUT PRIOR NOTICE. THIS DRAWING IS COPYRIGHT AND THE SOLE PROPERTY OF GLAZING VISION LTD. THE DESIGNS/INFORMATION IT CONTAINS ARE PRIVATE AND CONFIDENTIAL. IT MUST NOT BE COPIED, EXHIBITED OR COMMUNICATED TO THIRD PARTIES FOR ANY PURPOSE OTHER THAN THAT FOR WHICH IT WAS ISSUED WITHOUT THE WRITTEN PERMISSION OF GLAZING VISION LTD.	Third angle projection unless otherwise noted.  Tolerances:  Whole numbers = ±1mm  One decimal place = ±0.5mm  Two decimal places = ±0.2mm  All angles 90±0.5 degrees unless specified  <b>IF IN DOUBT - ASK! DO NOT SCALE</b> <b>Supplier to deburr &amp; remove sharp corners</b>	Rev	Revision Description	Drawn/ Date	Product: 201 - GV Standard Pitchglaze MkII Description: Raised Installation	Checked By:  HL	
			-	INITIAL ISSUE	JSL 12/04/2018	Materials: AS SITE HARDWARE LIST	Check Date:  08/11/2018	
			A	Difference between structural rafter/trimmer opening and internal viewable opening revised from 65mm	JSL 08/11/2018	Finish: -		Drawn By: JSL
						Weight: N/A		Drawn Date: 12/04/2018
						Quantity: -	Drawing No: 201-ASS-104	
				Scale: NTS				

**GV Standard Pitchglaze MkII****Small Frame**

Used for glass between 26mm & 34.8mm in thickness  
(typically double glazed units)

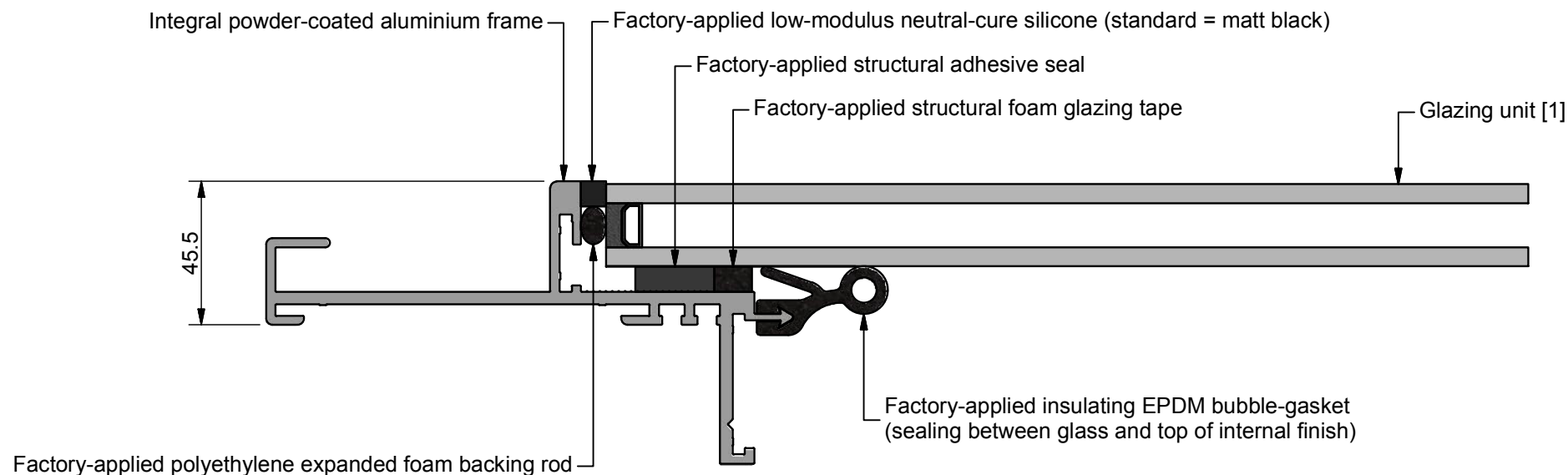
**For Both Frames**

For general dimensions, see GV drawing  
201-ASS-101

For installation information, see GV drawings  
201-ASS-102  
201-ASS-103  
201-ASS-104

**GV Standard Pitchglaze MkII****Large Frame**

Used for glass between 44mm & 52.8mm in thickness  
(typically triple glazed units)

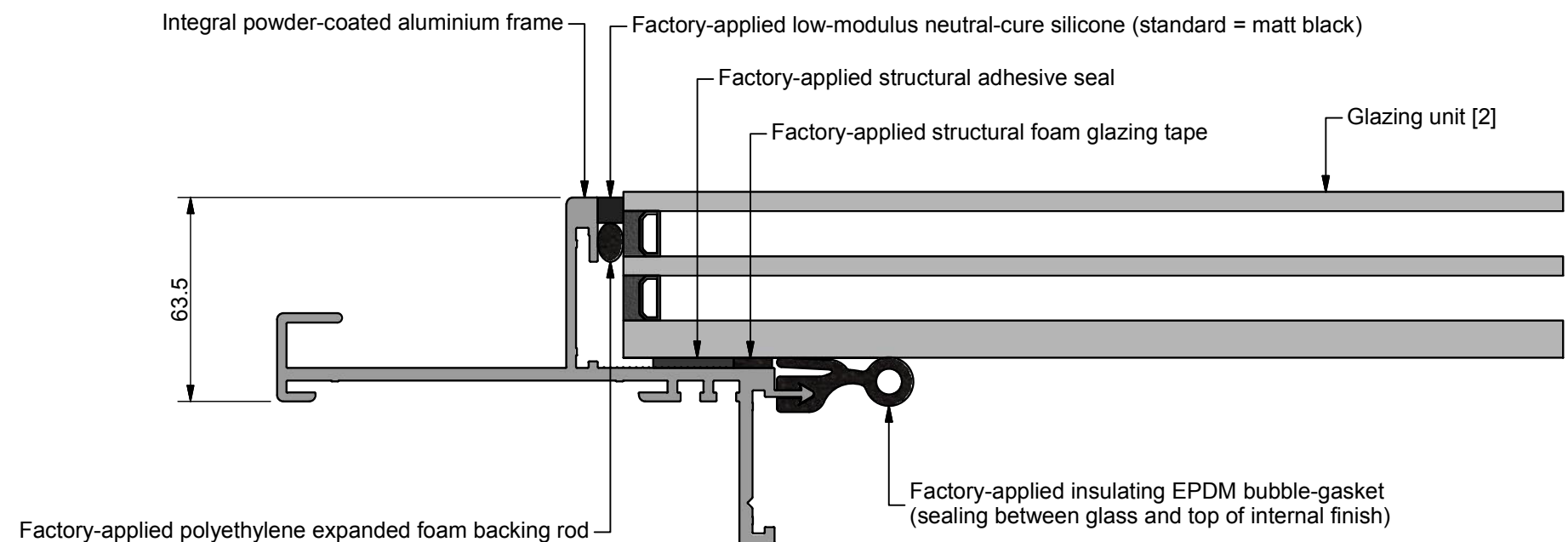

[1] Example glazing unit: Toughened double glazed unit  
- 6mm HST toughened outer pane  
- 16mm argon-filled cavity, black warm edge spacer  
- 6mm HST toughened soft coat low-E inner pane

[2] Example glazing unit: HS laminated triple glazed unit  
- 6mm HST toughened soft coat low-E outer pane  
- 14mm argon-filled cavity, black warm edge spacer  
- 6mm HST toughened soft coat low-E mid pane  
- 14mm argon-filled cavity, black warm edge spacer  
- 11.5mm HS-laminated inner pane

**GLAZING  
VISION**

Saw Mills Road  
Diss  
Norfolk  
IP22 4RG  
Tel: +44 (0)333 8000 881  
Fax: +44 (0)333 8000 882  
Email: sales@glazingvision.co.uk  
Website: www.glazingvision.co.uk

IT IS GLAZING VISION'S POLICY TO CONTINUOUSLY DEVELOP AND IMPROVE OUR PRODUCTS. WE THEREFORE RESERVE THE RIGHT TO MODIFY OR CHANGE THE DETAIL DESIGN AT OUR DISCRETION AND WITHOUT PRIOR NOTICE. THIS DRAWING IS COPYRIGHT AND THE SOLE PROPERTY OF GLAZING VISION LTD. THE DESIGNS/INFORMATION IT CONTAINS ARE PRIVATE AND CONFIDENTIAL. IT MUST NOT BE COPIED, EXHIBITED OR COMMUNICATED TO THIRD PARTIES FOR ANY PURPOSE OTHER THAN THAT FOR WHICH IT WAS ISSUED WITHOUT THE WRITTEN PERMISSION OF GLAZING VISION LTD.

Third angle projection unless otherwise noted.  
Tolerances:  
Whole numbers =  $\pm 1\text{mm}$   
One decimal place =  $\pm 0.5\text{mm}$   
Two decimal places =  $\pm 0.2\text{mm}$   
All angles  $90 \pm 0.5$  degrees unless specified  
**IF IN DOUBT - ASK! DO NOT SCALE**  
**Supplier to deburr & remove sharp corners**

Rev	Revision Description	Drawn/ Date	Product: 201 - GV Standard Pitchglaze MkII Description: Pitchglaze Components	Checked By: HL
-	INITIAL ISSUE	JSL 24/01/2018	<b>Materials:</b> - <b>Finish:</b> - <b>Weight:</b> N/A <b>Quantity:</b> - <b>Scale:</b> NTS	<b>Check Date:</b> 24/01/2018
			<b>Drawn By:</b> JSL <b>Drawn Date:</b> 24/01/2018 <b>Drawing No:</b> 201-ASS-105	