

## Secondary Control Switch or BMS Connection

This is a fixed installation. All connections should be carried out by a competent person.

For maintenance reasons the control switch must always be installed.

All cables supplied at 2 m, extendable to 10 m with appropriate cable.

All optional items must be specified at time of order.

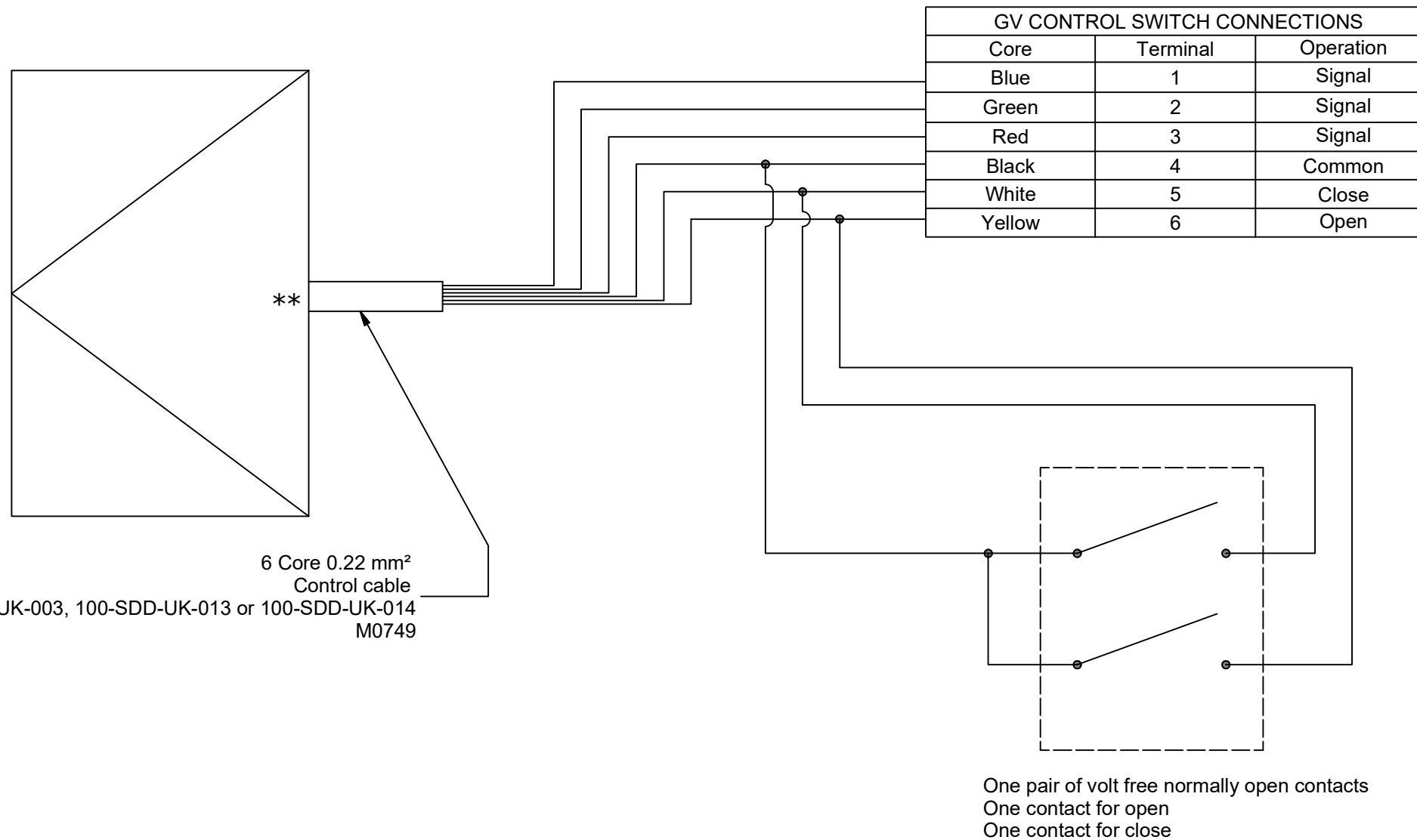

### One touch/Press and hold

Caution: Using latched contacts may render the product inoperable. To initiate a control cycle e.g. to open, close or stop the rooflight, switch the contact briefly (approx. 500 milliseconds - 5 seconds) to create one touch command. Please call Glazing Vision if you need assistance.

\*\*Cables exit from the underside of the product. See the upstand drawing for the exact exit position.

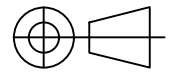

Third angle projection unless otherwise stated

THIS IS A STANDARD DRAWING. THE UNIT PURCHASED MAY VARY. THIS DRAWING DOES NOT INDICATE ACCURATE DIMENSIONS FOR ANY EXISTING STRUCTURAL COMPONENTS OR PRODUCTS.

DO NOT USE THIS DRAWING FOR ANY SITE LAYOUTS. ON-SITE PERSONNEL ARE RESPONSIBLE TO CONFIRM DRAWINGS VS SPECIFIC SITE CONDITIONS.

ESTIMATED WEIGHT	N/A	SCALE	Not to scale <small>(UNLESS OTHERWISE STATED)</small>
------------------	-----	-------	--

REVISION	DESCRIPTION	NAME/DATE
-	Initial Release	HL 09/Dec/2020

PROJECT	
Universal Controller MA0106 Wiring Diagrams	
TITLE / DESCRIPTION	CHECKED
Secondary Control Switch or BMS Connection	MJM
DRAWING NO.	SHEET
100-SDD-UK-004	1 OF 1