

**GV STANDARD SLIDING OVER FIXED**  
ELECTRONICALLY OPERATED SLIDING ROOFLIGHT

**Closed position**

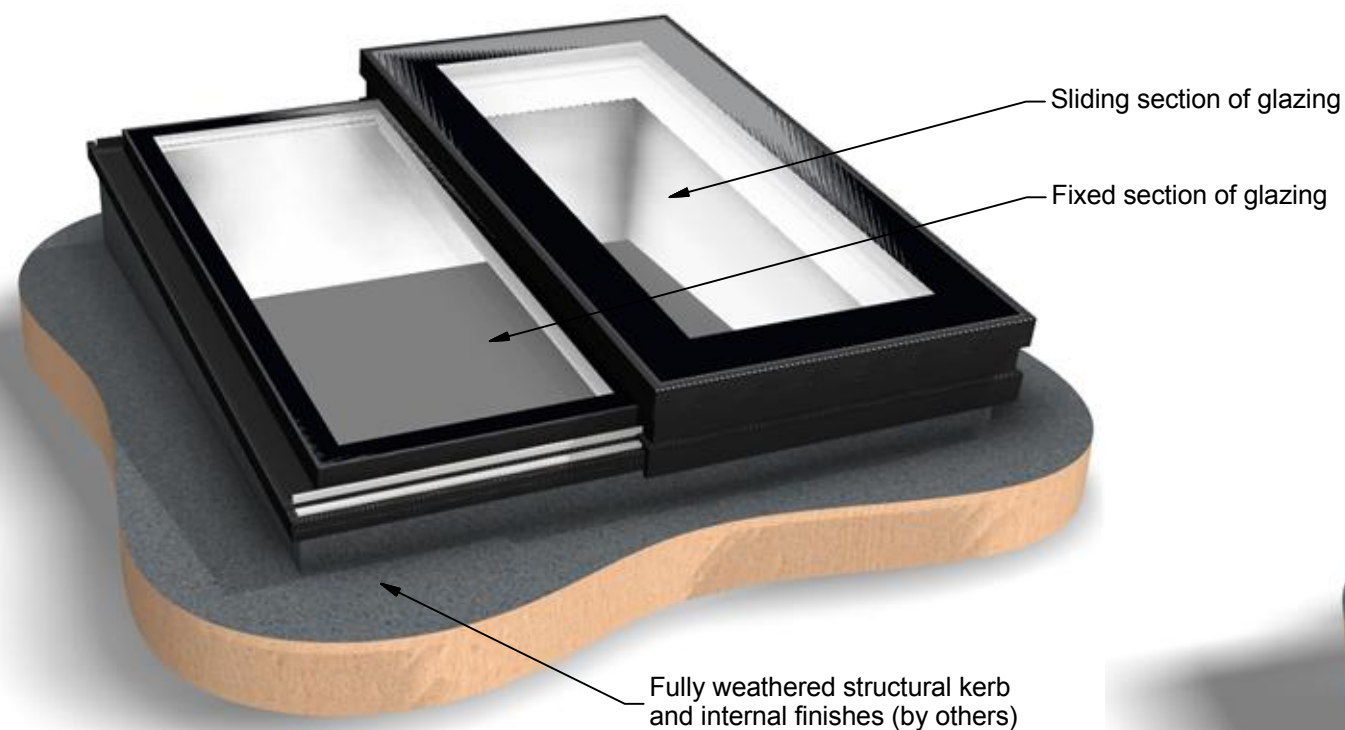

**Open position**

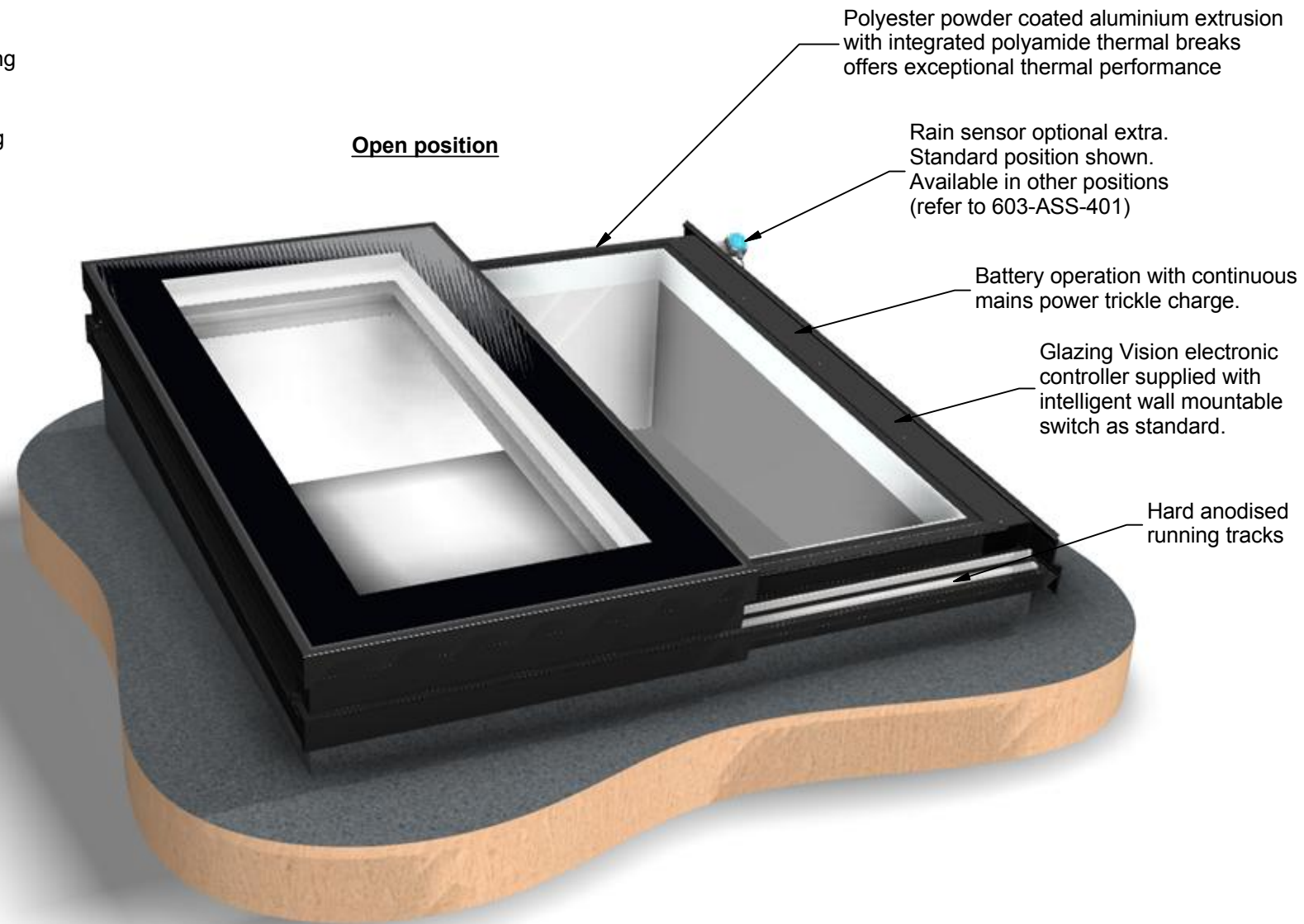

**Internal drive detail**

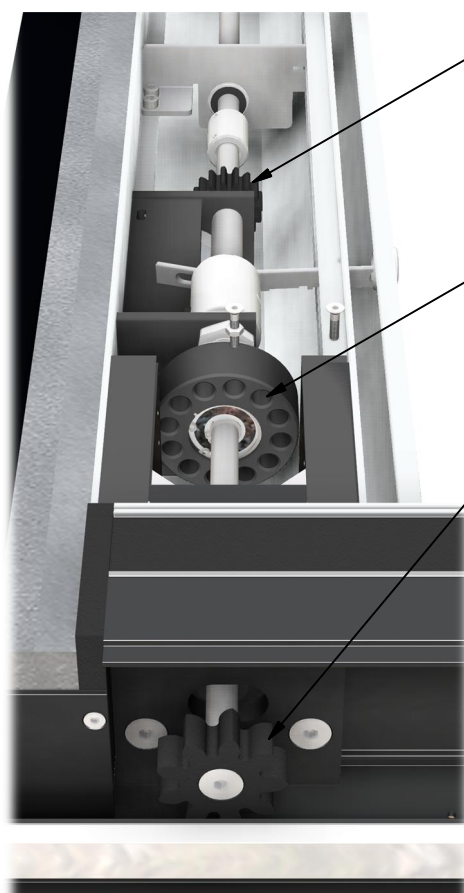

Twin drive motor mechanism comprising planetary motor concealed within centre framework ensures optimum performance.

One way clutch and solenoid security feature (patent applied for) as standard, allows unit to be closed without power. Hidden internal override allows unit to be opened without power.

Rack and pinion drive

**FEA MODELLED FOR STRUCTURAL INTEGRITY**

**THERMALLY MODELLED FOR INDUSTRY LEADING EFFICIENCY**

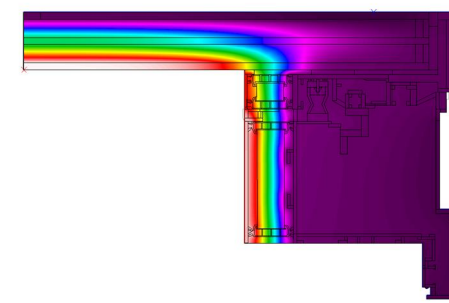

**REQUIRES WEATHERED KERB (NOT SUPPLIED)**  
**REFER TO DRAWINGS:**  
603-ASS-402  
603-ASS-403  
603-ASS-404  
603-ASS-405  
603-ASS-406  
**FOR DETAILS**

Rev	Revision Description	Drawn/Date
-	Initial release	PGW 25.02.2014

<b>Product:</b> 603 - GV Standard Sliding Over Fixed		<b>Checked By:</b> JamesB
<b>Description:</b> Product overview		<b>Check Date:</b> 25.02.2014
<b>Materials:</b> N/A	<b>Drawn By:</b> PGW	
<b>Finish:</b> Standard = RAL7015/RAL9010	<b>Drawn Date:</b> 25.02.2014	
<b>Weight:</b>	<b>Quantity:</b> N/A	
<b>Scale:</b> NTS	<b>Drawing No:</b> 603-ASS-400	