

Section A-A (Scale 1 : 1)

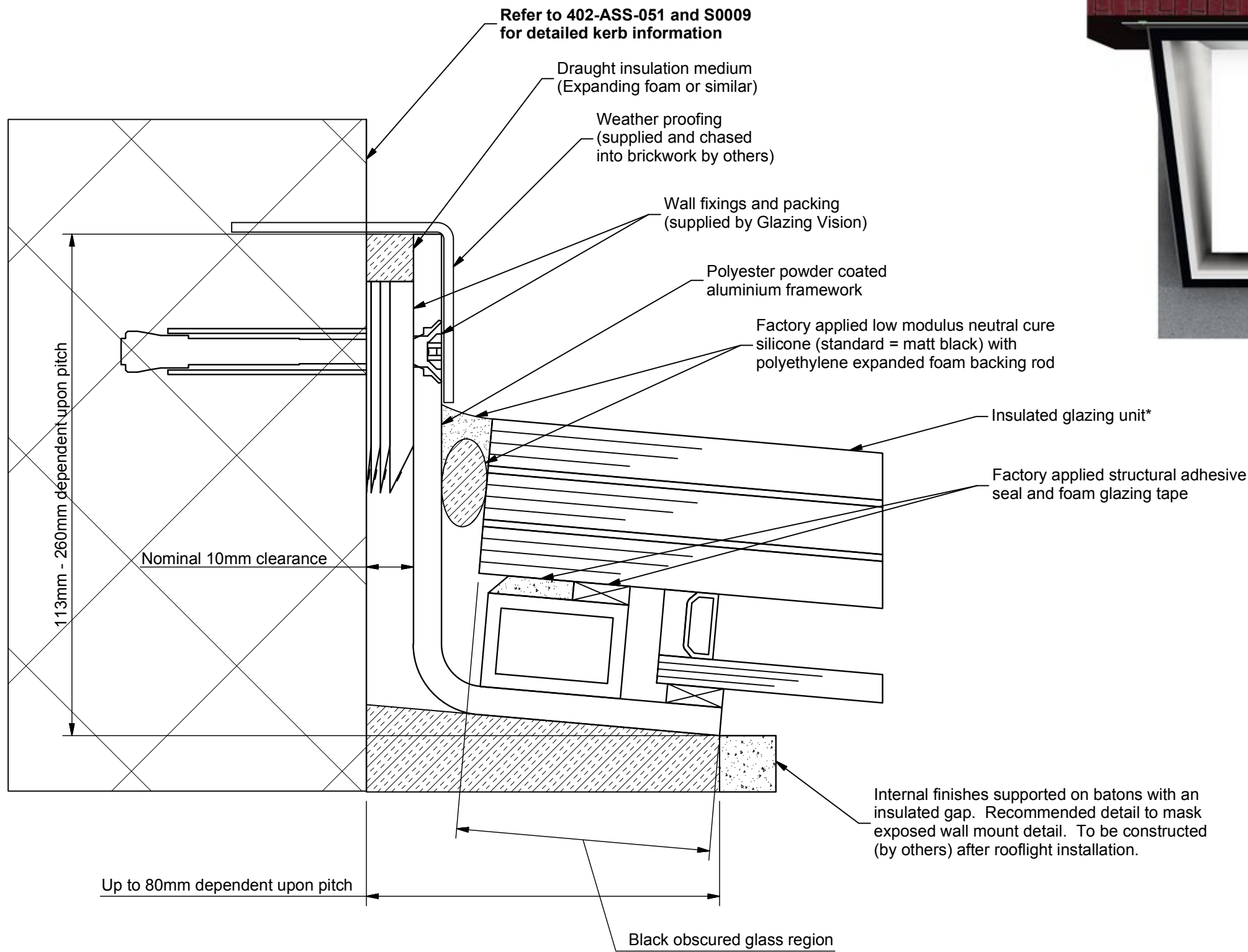

Plan view (NTS)



Wall abutment inset detail (NTS)

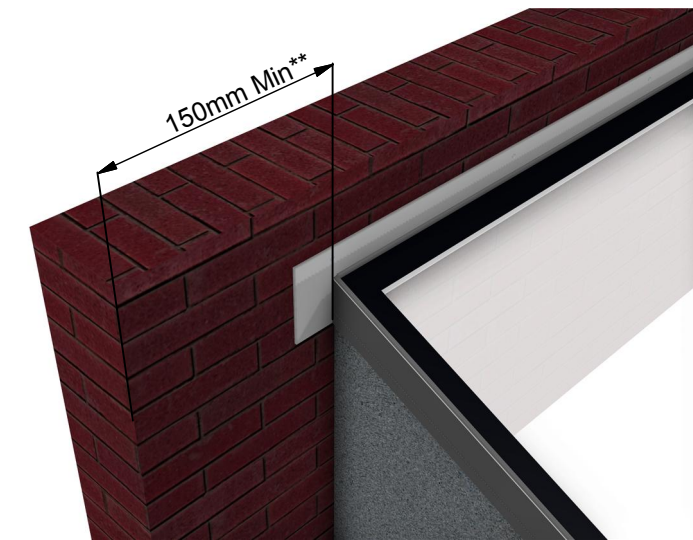

NOTE: Weathering flashing (by others) not shown on 3D views for clarity of Glazing Vision detail.

*Specification dependent on client options and glazing area

** Wall **must** extend a minimum of 150mm beyond outside face of kerb to ensure correct weathering (see top detail).

These views are of a 2 wall abutted Flushglaze, many other configuration options are available. **Please contact Glazing Vision to discuss your requirements.**

Rev	Revision Description	Drawn/Date
-	Initial release	DR 13.02.15
A	Detail shown changed to 5deg angle	JSL 22.01.18

Product: 402 - GV Standard Flushglaze		Checked By: SW
Description: Wall abutment detail (Walk-on) for oversize units		
Materials: As above		Check Date: 22.01.18
Finish: Std=RAL 7015	Drawn By: JWL	
Weight: N/A	Drawn Date: 06.02.15	
Quantity: N/A	Drawing No: 402-ASS-062	
Scale: See above		