

Section A-A (Scale 1 : 1)

Refer to 402-ASS-051 and S0009 for detailed kerb information

Draught insulation medium (Expanding foam or similar)

Weather proofing (supplied and chased into brickwork by others)

Wall fixings and packing (supplied by Glazing Vision)

Polyester powder coated aluminium framework

Factory applied low modulus neutral cure silicone (standard = matt black) with polyethylene expanded foam backing rod

Factory applied structural adhesive seal and foam glazing tape

Insulated glazing unit*

Required Detail- Internal finishes supported on batons with an insulated gap to mask exposed wall mount detail. To be constructed (by others) after rooflight installation

Black obscured glass region

113mm - 260mm dependent upon pitch

Nominal 10mm clearance

Up to 80mm dependent upon pitch

Plan view (NTS)



Wall abutment inset detail (NTS)

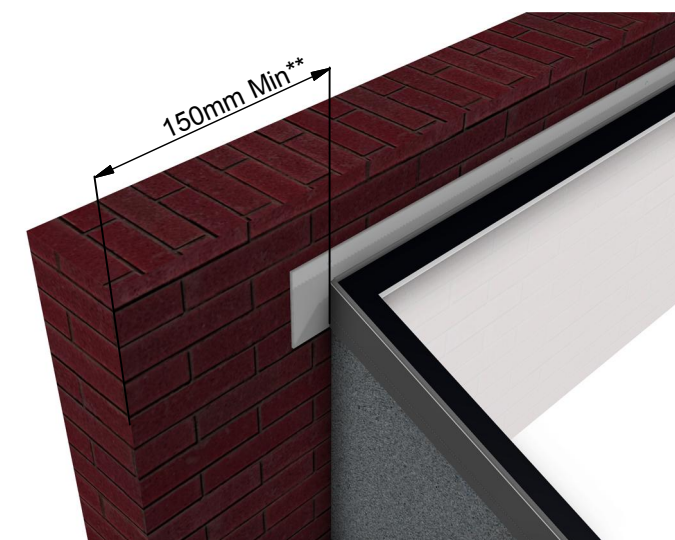

NOTE: Weathering flashing (by others) not shown on 3D views for clarity of Glazing Vision detail.

*Specification dependent on client options and glazing area

** Wall **must** extend a minimum of 150mm beyond outside face of kerb to ensure correct weathering (see top detail).

These views are of a 2 wall abutted Flushglaze, many other configuration options are available. **Please contact Glazing Vision to discuss your requirements.**



Saw Mills Road
Diss
Norfolk
IP22 4RG
Tel: +44 (0)333 8000 881
Fax: +44 (0)333 8000 882
Email: sales@glazingvision.co.uk
Website: www.glazingvision.co.uk

IT IS GLAZING VISION'S POLICY TO CONTINUOUSLY DEVELOP AND IMPROVE OUR PRODUCTS. WE THEREFORE RESERVE THE RIGHT TO MODIFY OR CHANGE THE DETAIL DESIGN AT OUR DISCRETION AND WITHOUT PRIOR NOTICE. THIS DRAWING IS COPYRIGHT AND THE SOLE PROPERTY OF GLAZING VISION LTD. THE DESIGNS/INFORMATION IT CONTAINS ARE PRIVATE AND CONFIDENTIAL. IT MUST NOT BE COPIED, EXHIBITED OR COMMUNICATED TO THIRD PARTIES FOR ANY PURPOSE OTHER THAN THAT FOR WHICH IT WAS ISSUED WITHOUT THE WRITTEN PERMISSION OF GLAZING VISION LTD.

Third angle projection unless otherwise noted.
Tolerances:
Whole numbers = ±1mm
One decimal place = ±0.5mm
Two decimal places = ±0.2mm
All angles 90±0.5 degrees unless specified
IF IN DOUBT - ASK! DO NOT SCALE
Supplier to deburr & remove sharp corners

Rev	Revision Description	Drawn/Date	Product: 402 - GV Standard Flushglaze	Checked By:
B	Description updated to suit 2017 MPFG	JSL 19.12.17	Description: Wall abutment detail (DGU) for folded-sheet wall abutments	JWL
A	'Internal finishes' note amended	SW 03.08.16	Materials: As above Finish: Std=RAL 7015 Weight: N/A Quantity: N/A Scale: See above	Check Date: 03.08.16
			Drawn By: DylanR Drawn Date: 30.06.14 Drawing No: 402-ASS-058	