

## Keypad Connection (Strikemaster E0102)

This is a fixed installation using Glazing Vision's supplied keypad. All connections should be carried out by a competent person.

All cables supplied at 2 m, extendable to 10 m with appropriate cable.

All optional items must be specified at time of order.

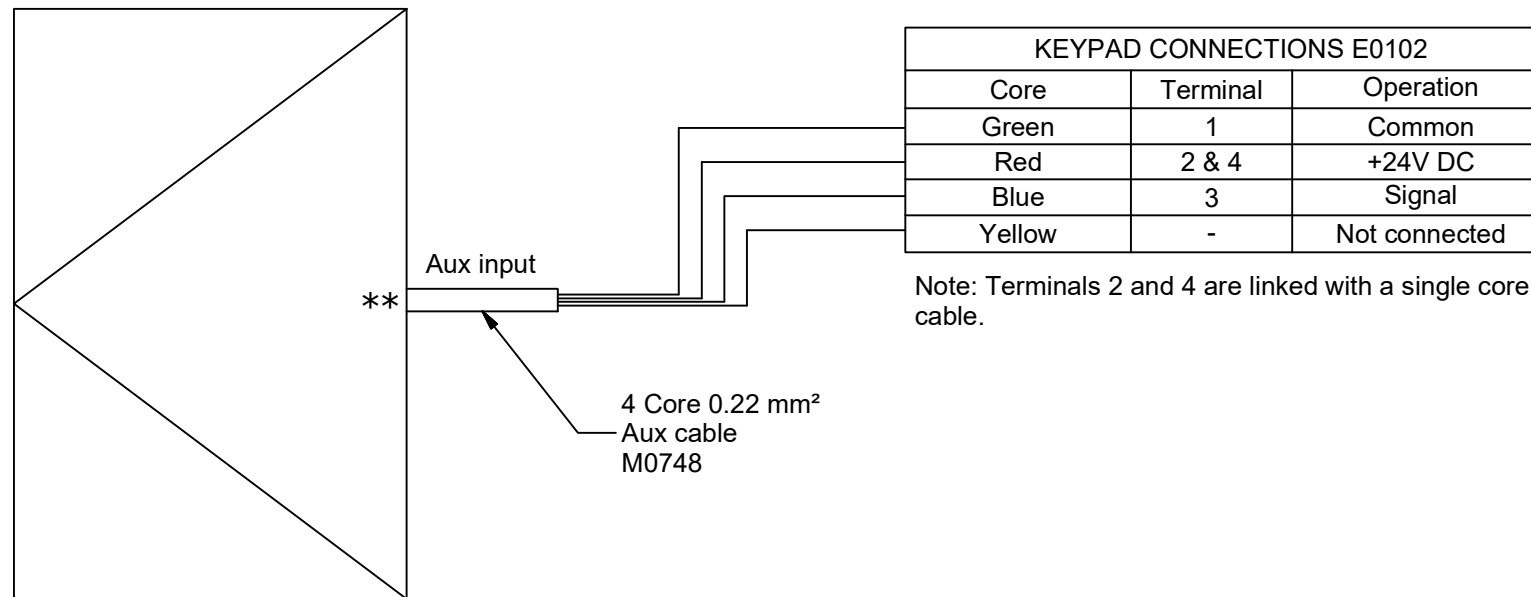

**\*\*** Cables exit from the underside of the product. See the upstand drawing for the exact exit position.

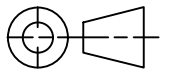

ESTIMATED WEIGHT N/A		SCALE Not to scale <small>(UNLESS OTHERWISE STATED)</small>	
REVISION	DESCRIPTION	NAME/DATE	
-	Initial Release	HL 09/Dec/2020	
PROJECT Universal Controller MA0106 Wiring Diagrams			
TITLE / DESCRIPTION		CHECKED	
Keypad Connection (Strikemaster E0102)		MJM	
DRAWING NO. 100-SDD-UK-012		SHEET 1 OF 1	